

Soils Map - Tillable Acres - Tract 1

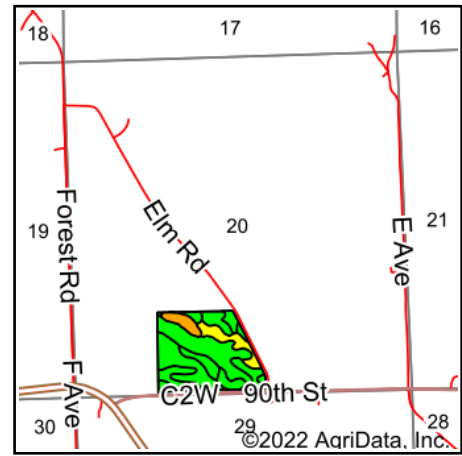

State: **Iowa**
 County: **Fayette**
 Location: **20-92N-7W**
 Township: **Fairfield**
 Acres: **42.36**
 Date: **10/19/2022**

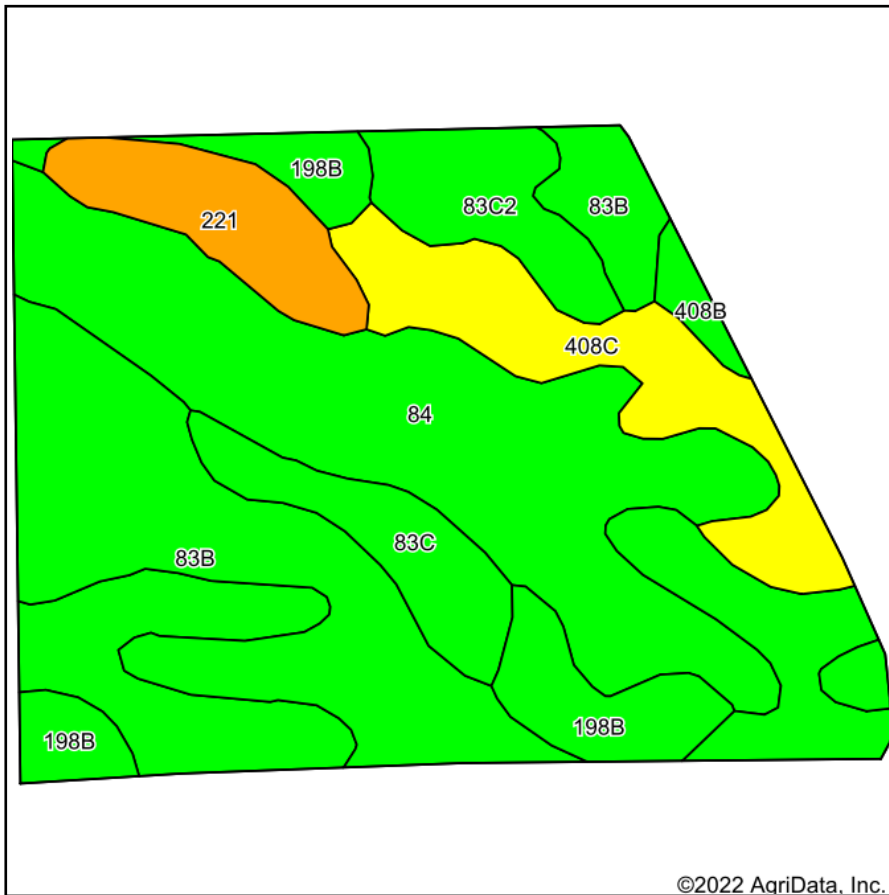

Maps Provided By:



© AgriData, Inc. 2021

www.AgriDataInc.com



Soils data provided by USDA and NRCS.

©2022 AgriData, Inc.

Area Symbol: IA065, Soil Area Version: 26

Code	Soil Description	Acres	Percent of field	CSR2 Legend	Non-Irr Class *c	*i Corn Bu	*i Alfalfa Tons	*i Soybeans Bu	CSR2**	Corn Bu	Oats Bu	Soybeans Bu	*n NCCPI Overall	
84	Clyde clay loam, 0 to 3 percent slopes	14.85	35.1%		llw	224.0	4.7	65.0	88				90	
83B	Kenyon loam, 2 to 5 percent slopes	11.95	28.2%		lle	225.6	6.3	65.4	90	210	91	61	87	
408C	Olin fine sandy loam, 5 to 9 percent slopes	4.29	10.1%		llle	180.8	5.1	52.4	69				78	
198B	Floyd loam, 1 to 4 percent slopes	3.45	8.1%		llw	222.4	5.8	64.5	89				85	
221	Klossner muck, 1 to 4 percent slopes	2.52	5.9%		lllw	80.0	1.7	23.2	48				88	
83C	Kenyon loam, 5 to 9 percent slopes	2.27	5.4%		llle	209.6	5.9	60.8	85	188	90.5	48.5	86	
83C2	Kenyon loam, 5 to 9 percent slopes, eroded	2.26	5.3%		llle	204.8	5.7	59.4	84	212	88	61	78	
408B	Olin fine sandy loam, 2 to 5 percent slopes	0.77	1.8%		lle	196.8	5.5	57.1	73				79	
Weighted Average						2.27	209.1	5.2	60.6	83.7	80.6	35.2	23.1	*n 86.4

**IA has updated the CSR values for each county to CSR2.

*i Yield data provided by the ISPAID Database version 8.1.1 developed by IA State University.

*n: The aggregation method is "Weighted Average using all components"

*c: Using Capabilities Class Dominant Condition Aggregation Method

Soils data provided by USDA and NRCS.