

# Tillable Soils Map

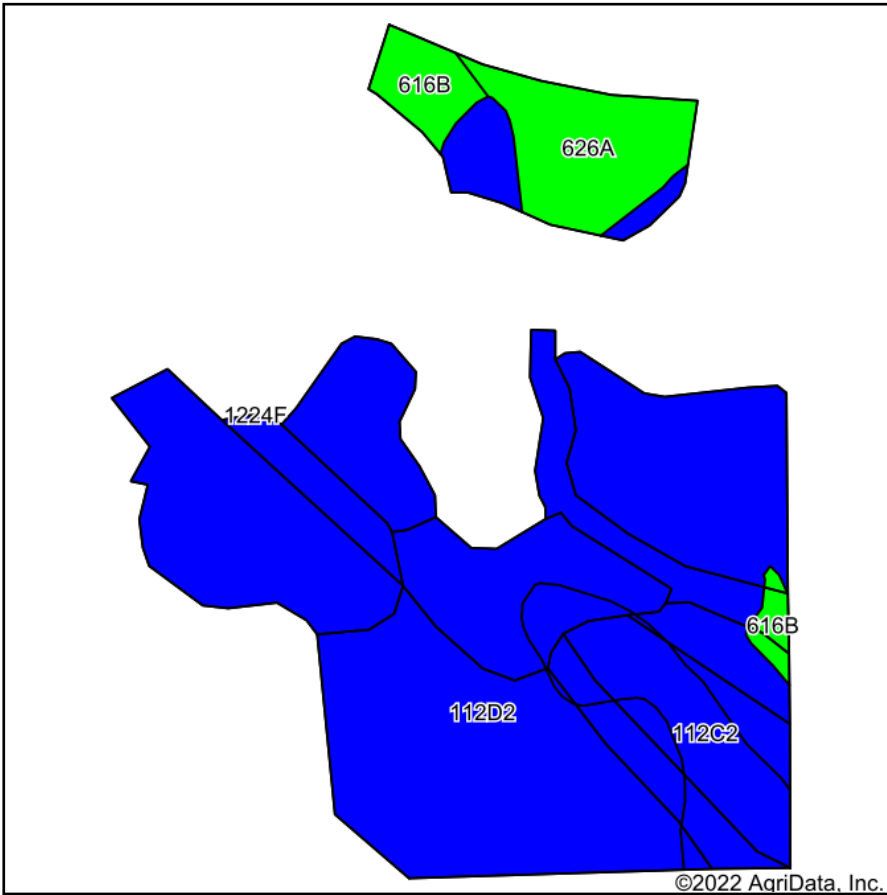

Soils data provided by USDA and NRCS.

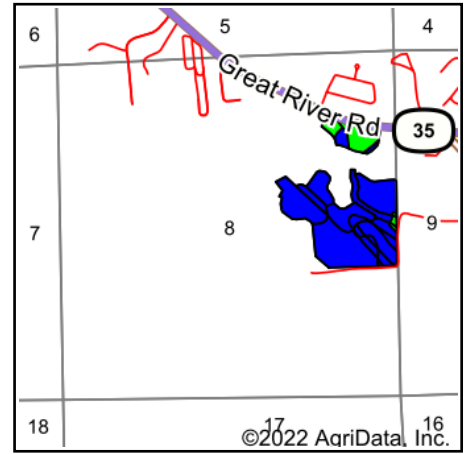

State: **Wisconsin**  
 County: **Crawford**  
 Location: **8-6N-6W**  
 Township: **Bridgeport**  
 Acres: **50.85**  
 Date: **11/1/2022**



Maps Provided By:



Area Symbol: WI023, Soil Area Version: 15

Code	Soil Description	Acres	Percent of field	NCCPI Overall Legend	Non-Irr Class	*n NCCPI Overall
112D2	Seaton silt loam, 12 to 20 percent slopes, vfst substratum, moderately eroded	39.64	78.0%		IVe	73
112C2	Seaton silt loam, 6 to 12 percent slopes, vfst substratum, moderately eroded	5.26	10.3%		IIIe	79
626A	Arenzville silt loam, 0 to 3 percent slopes, occasionally flooded	4.05	8.0%		IIw	88
616B	Chaseburg silt loam, 1 to 4 percent slopes, occasionally flooded	1.90	3.7%		Ile	90
<b>Weighted Average</b>					<b>3.66</b>	<b>*n 75.5</b>

\*n: The aggregation method is "Weighted Average using all components"  
 Soils data provided by USDA and NRCS.