

# Soils Map

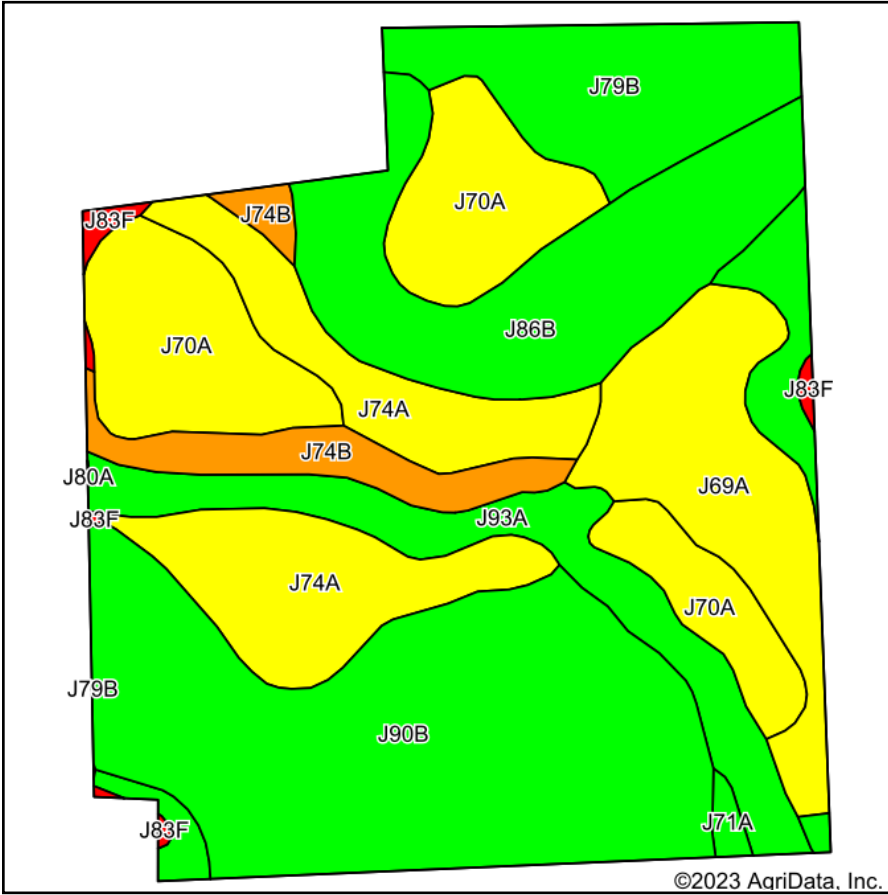

Soils data provided by USDA and NRCS.

©2023 AgriData, Inc.

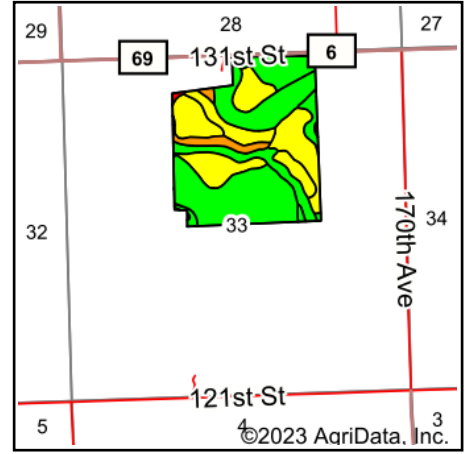

State: **Minnesota**  
 County: **Pipestone**  
 Location: **33-107N-44W**  
 Township: **Rock**  
 Acres: **121.9**  
 Date: **5/16/2023**



Maps Provided By:



© AgriData, Inc. 2023

www.AgriDataInc.com



Area Symbol: MN117, Soil Area Version: 22

Code	Soil Description	Acres	Percent of field	PI Legend	Non-Irr Class *c	Productivity Index	*n NCCPI Overall	
J90B	Kranzburg-Brookings silty clay loams, 1 to 6 percent slopes	31.80	26.1%		Ile	93	69	
J70A	Brandt silty clay loam, 0 to 2 percent slopes	18.27	15.0%		Is	80	71	
J86B	Vienna silty clay loam, 3 to 6 percent slopes	16.79	13.8%		Ile	90	63	
J74A	Estelline silt loam, coteau, 0 to 2 percent slopes	15.35	12.6%		Ils	75	59	
J69A	Athelwold silty clay loam, 0 to 2 percent slopes	11.57	9.5%		Is	80	63	
J79B	Vienna-Brookings complex, 1 to 6 percent slopes	9.74	8.0%		Ile	94	68	
J93A	Hidewood-Badger complex, 0 to 2 percent slopes	9.08	7.4%		Ilw	92	69	
J74B	Estelline silt loam, coteau, 2 to 6 percent slopes	5.03	4.1%		Ile	70	57	
J71A	Brookings silty clay loam, 0 to 2 percent slopes	3.53	2.9%		Iw	98	77	
J83F	Sandberg-Buse-Everts complex, 12 to 40 percent slopes	0.74	0.6%		Vlle	23	23	
<b>Weighted Average</b>						<b>1.76</b>	<b>85.9</b>	<b>*n 66</b>

\*n: The aggregation method is "Weighted Average using all components"

\*c: Using Capabilities Class Dominant Condition Aggregation Method

Soils data provided by USDA and NRCS.