

Tillable Soils Map

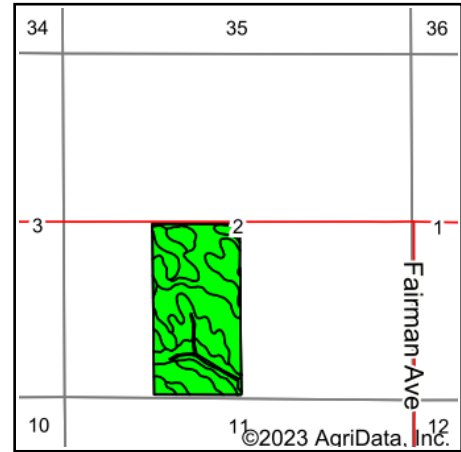

State: **Iowa**
 County: **Marshall**
 Location: **2-85N-20W**
 Township: **Liberty**
 Acres: **79.04**
 Date: **6/7/2023**

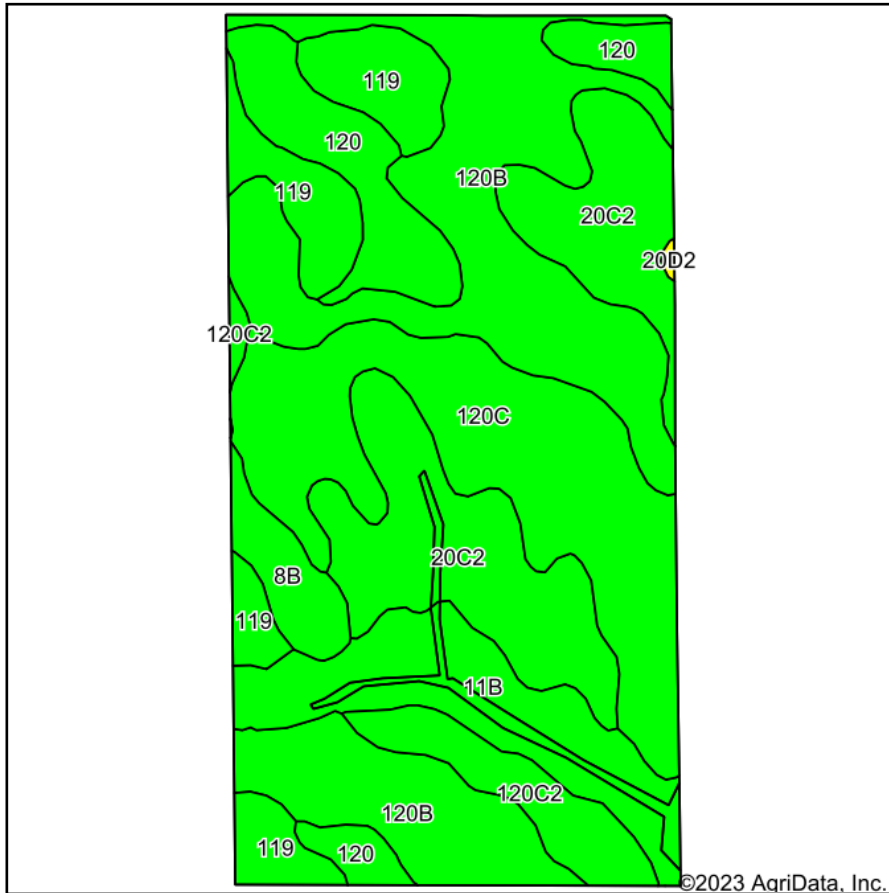

Maps Provided By:



© AgriData, Inc. 2023

www.AgriDataInc.com



Soils data provided by USDA and NRCS.

Area Symbol: IA127, Soil Area Version: 27

Code	Soil Description	Acres	Percent of field	CSR2 Legend	Non-Irr Class *c	CSR2**	CSR	*n NCCPI Overall	*n NCCPI Corn	*n NCCPI Soybeans	
120B	Tama silty clay loam, 2 to 5 percent slopes	21.32	27.0%		Ile	95	95	97	97	80	
120C	Tama silty clay loam, 5 to 9 percent slopes	15.41	19.5%		IIle	90	80	93	93	77	
20C2	Killduff silty clay loam, 5 to 9 percent slopes, eroded	14.35	18.2%		IIIle	81	73	87	87	78	
11B	Colo-Ely complex, 0 to 5 percent slopes	7.91	10.0%		IIw	86	68	92	92	76	
119	Muscatine silty clay loam, 0 to 2 percent slopes	7.25	9.2%		Iw	100	100	96	96	91	
120	Tama silty clay loam, 0 to 2 percent slopes	6.88	8.7%		I	100	100	95	95	79	
120C2	Tama silty clay loam, 5 to 9 percent slopes, eroded	3.66	4.6%		IIIle	87	78	89	89	70	
8B	Judson silty clay loam, 2 to 5 percent slopes	2.18	2.8%		Ile	93	90	95	94	82	
20D2	Killduff silty clay loam, 9 to 14 percent slopes, eroded	0.08	0.1%		IIIle	55	63	83	83	73	
Weighted Average						2.25	91	85.3	*n 93.2	*n 93.2	*n 79.2

**IA has updated the CSR values for each county to CSR2.

*n: The aggregation method is "Weighted Average using all components"

*c: Using Capabilities Class Dominant Condition Aggregation Method

Soils data provided by USDA and NRCS.