

# Soils Map

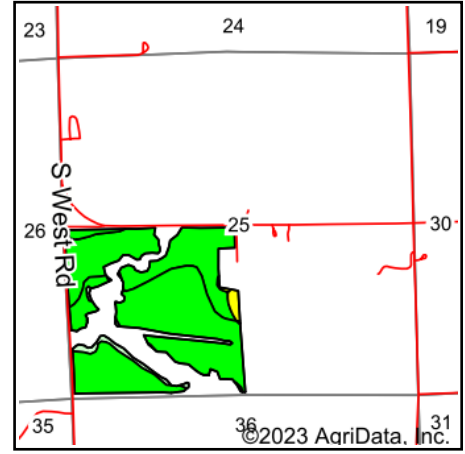

State: **Kansas**  
 County: **Sumner**  
 Location: **25-32S-1W**  
 Township: **Wellington**  
 Acres: **115.7**  
 Date: **6/6/2023**



Soils data provided by USDA and NRCS.

Area Symbol: KS191, Soil Area Version: 19

Code	Soil Description	Acres	Percent of field	Non-Irr Class Legend	Non-Irr Class *c	*n NCCPI Overall
6220	Brewer silty clay loam, rarely flooded	68.42	59.1%		Iw	63
6246	Elandco silty clay loam, rarely flooded	40.17	34.7%		IIw	72
9998	Ustifluvents, channeled	3.54	3.1%			
6369	Milan loam, 1 to 3 percent slopes	1.66	1.4%		IIe	73
3909	Rosehill clay loam, 3 to 6 percent slopes	1.50	1.3%		IVe	40
5957	Shellabarger sandy loam, 3 to 6 percent slopes	0.25	0.2%		IIIe	60
5465	Wellsford-Renfrow clay loams, 2 to 6 percent slopes, eroded	0.16	0.1%		VIe	21
<b>Weighted Average</b>					<b>*-</b>	<b>*n 64</b>

\*n: The aggregation method is "Weighted Average using all components"

\*c: Using Capabilities Class Dominant Condition Aggregation Method

\*- Non Irr Class weighted average cannot be calculated on the current soils data due to missing data.

Soils data provided by USDA and NRCS.