

# Soils Map

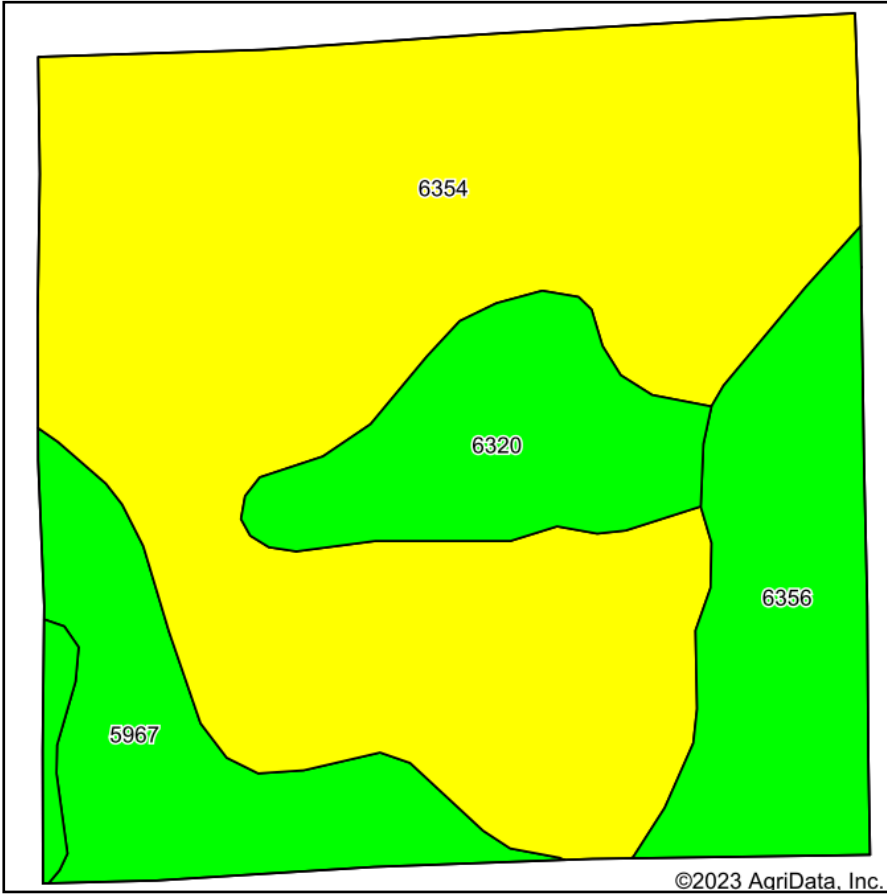

Soils data provided by USDA and NRCS.

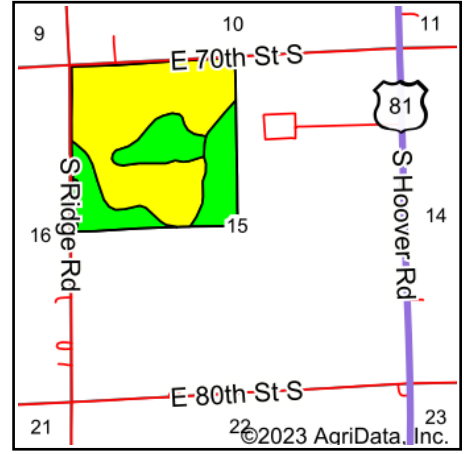

State: **Kansas**  
 County: **Sumner**  
 Location: **15-33S-1W**  
 Township: **Jackson**  
 Acres: **155.41**  
 Date: **6/6/2023**



Maps Provided By:



Area Symbol: KS191, Soil Area Version: 19

Code	Soil Description	Acres	Percent of field	Non-Irr Class Legend	Non-Irr Class *c	*n NCCPI Overall
6354	Kirkland silt loam, 0 to 1 percent slopes, cool	98.76	63.5%		IIIs	44
6356	Kirkland silt loam, 1 to 3 percent slopes	22.34	14.4%		IIs	43
5967	Tabler silty clay loam, 0 to 1 percent slopes	17.78	11.4%		IIw	43
6320	Bethany silt loam, 0 to 1 percent slopes	16.53	10.6%		IIs	58
<b>Weighted Average</b>					<b>2.64</b>	<b>*n 45.2</b>

\*n: The aggregation method is "Weighted Average using all components"

\*c: Using Capabilities Class Dominant Condition Aggregation Method

Soils data provided by USDA and NRCS.