

# Soils Map

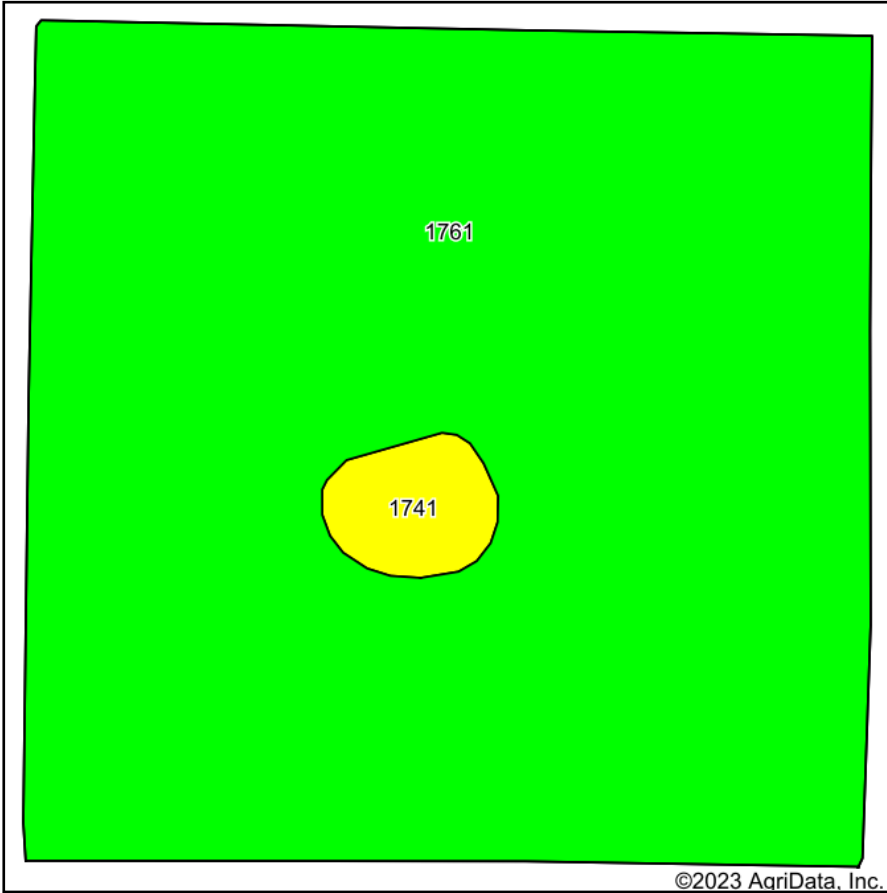

Soils data provided by USDA and NRCS.

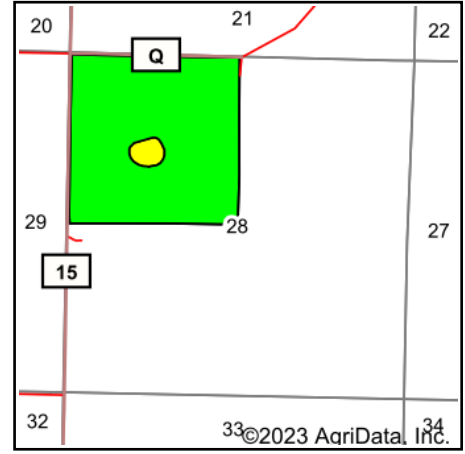

State: **Kansas**  
 County: **Wichita**  
 Location: **28-18S-36W**  
 Township: **Leoti**  
 Acres: **156.47**  
 Date: **6/27/2023**



Maps Provided By:



© AgriData, Inc. 2023

www.AgriDataInc.com



Area Symbol: KS203, Soil Area Version: 19

Code	Soil Description	Acres	Percent of field	Non-Irr Class Legend	Non-Irr Class *c	Irr Class *c	*n NCCPI Overall
1761	Richfield silt loam, 0 to 1 percent slopes	152.07	97.2%		IIIc	I	65
1741	Pleasant silty clay loam, ponded	4.40	2.8%		IVw	IVw	7
<b>Weighted Average</b>					<b>3.03</b>	<b>1.08</b>	<b>*n 63.4</b>

\*n: The aggregation method is "Weighted Average using all components"

\*c: Using Capabilities Class Dominant Condition Aggregation Method

Soils data provided by USDA and NRCS.