

Soils Map

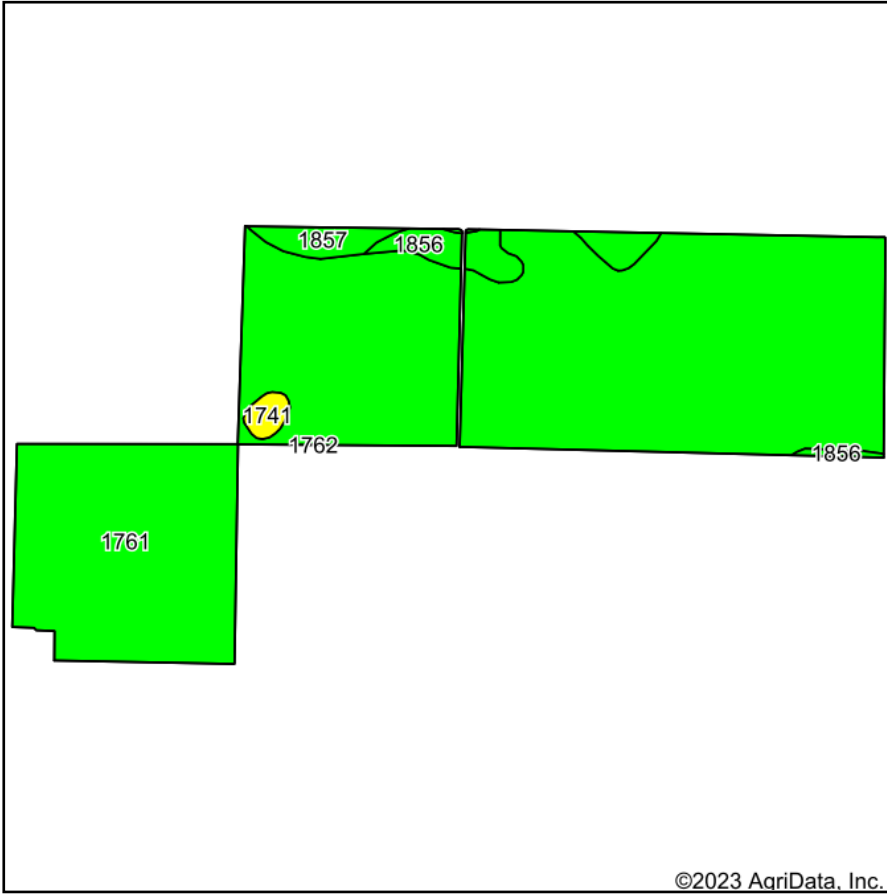

Soils data provided by USDA and NRCS.

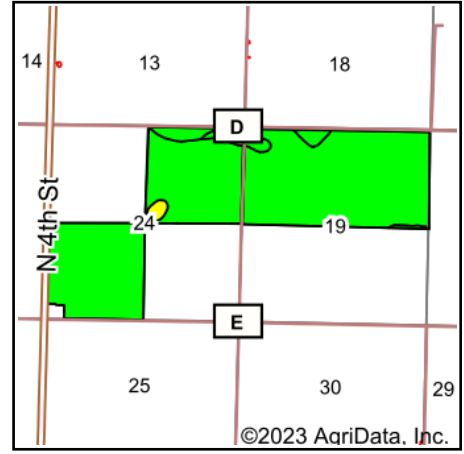

State: **Kansas**
 County: **Wichita**
 Location: **24-16S-37W**
 Township: **Leoti**
 Acres: **613.52**
 Date: **6/27/2023**



Maps Provided By:



© AgriData, Inc. 2023

www.AgriDataInc.com



Area Symbol: KS203, Soil Area Version: 19

Code	Soil Description	Acres	Percent of field	Non-Irr Class Legend	Non-Irr Class *c	Irr Class *c	*n NCCPI Overall
1761	Richfield silt loam, 0 to 1 percent slopes	574.82	93.7%		IIIc	I	65
1857	Ulysses silt loam, 1 to 3 percent slopes	17.46	2.8%		IIIe	Ile	64
1856	Ulysses silt loam, 0 to 1 percent slopes	16.30	2.7%		IIc	Iw	63
1741	Pleasant silty clay loam, ponded	4.94	0.8%		IVw	IVw	7
Weighted Average					2.98	1.05	*n 64.5

*n: The aggregation method is "Weighted Average using all components"

*c: Using Capabilities Class Dominant Condition Aggregation Method

Soils data provided by USDA and NRCS.