

# Soils Map

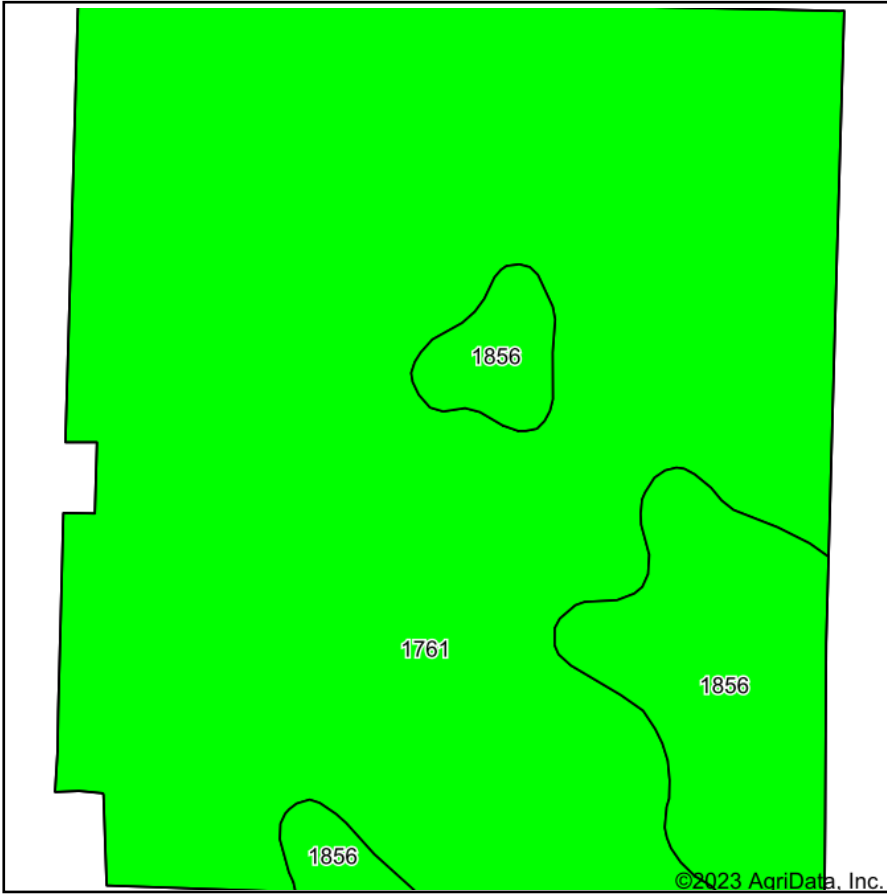

Soils data provided by USDA and NRCS.

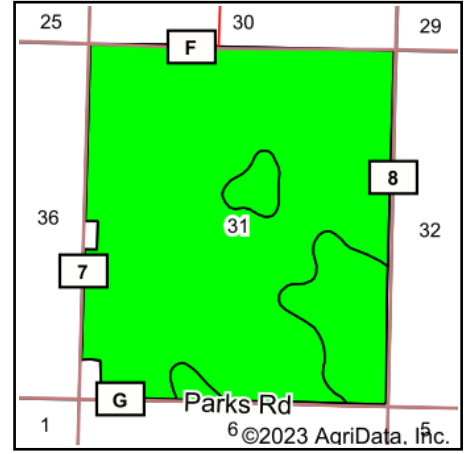

State: **Kansas**  
 County: **Wichita**  
 Location: **31-16S-37W**  
 Township: **Leoti**  
 Acres: **539.72**  
 Date: **6/27/2023**



Maps Provided By:



Area Symbol: KS203, Soil Area Version: 19

Code	Soil Description	Acres	Percent of field	Non-Irr Class Legend	Non-Irr Class *c	Irr Class *c	*n NCCPI Overall
1761	Richfield silt loam, 0 to 1 percent slopes	462.64	85.7%		IIIc	I	65
1856	Ulysses silt loam, 0 to 1 percent slopes	77.08	14.3%		IIc	Iw	63
<b>Weighted Average</b>					<b>2.86</b>	<b>1.00</b>	<b>*n 64.7</b>

\*n: The aggregation method is "Weighted Average using all components"

\*c: Using Capabilities Class Dominant Condition Aggregation Method

Soils data provided by USDA and NRCS.