

# Soils Map

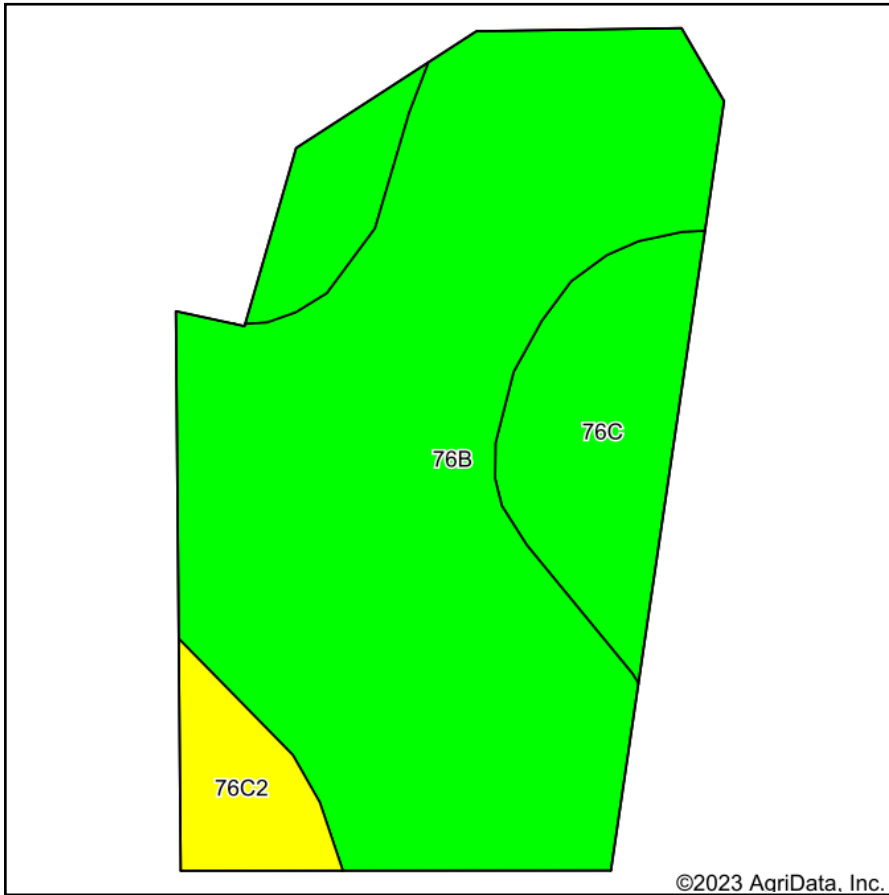

Soils data provided by USDA and NRCS.

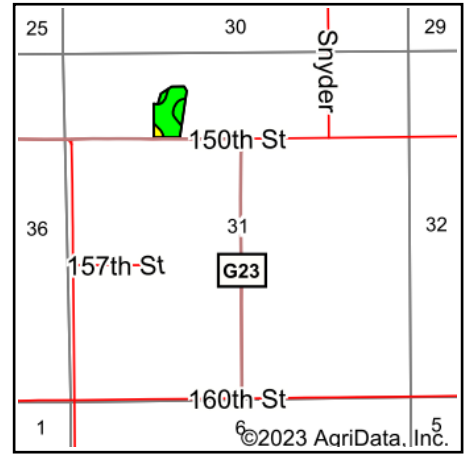

State: **Iowa**  
 County: **Mahaska**  
 Location: **31-77N-14W**  
 Township: **Pleasant Grove**  
 Acres: **7.24**  
 Date: **6/21/2023**



Maps Provided By:



Area Symbol: IA123, Soil Area Version: 28

Code	Soil Description	Acres	Percent of field	CSR2 Legend	CSR2**	CSR
76B	Ladoga silt loam, 2 to 5 percent slopes	5.33	73.6%		86	87
76C	Ladoga silt loam, 5 to 9 percent slopes	1.47	20.3%		79	72
76C2	Ladoga silt loam, 5 to 9 percent slopes, eroded	0.44	6.1%		75	68
<b>Weighted Average</b>					<b>83.9</b>	<b>82.8</b>

\*\*IA has updated the CSR values for each county to CSR2.  
 Soils data provided by USDA and NRCS.