

# Soils Map

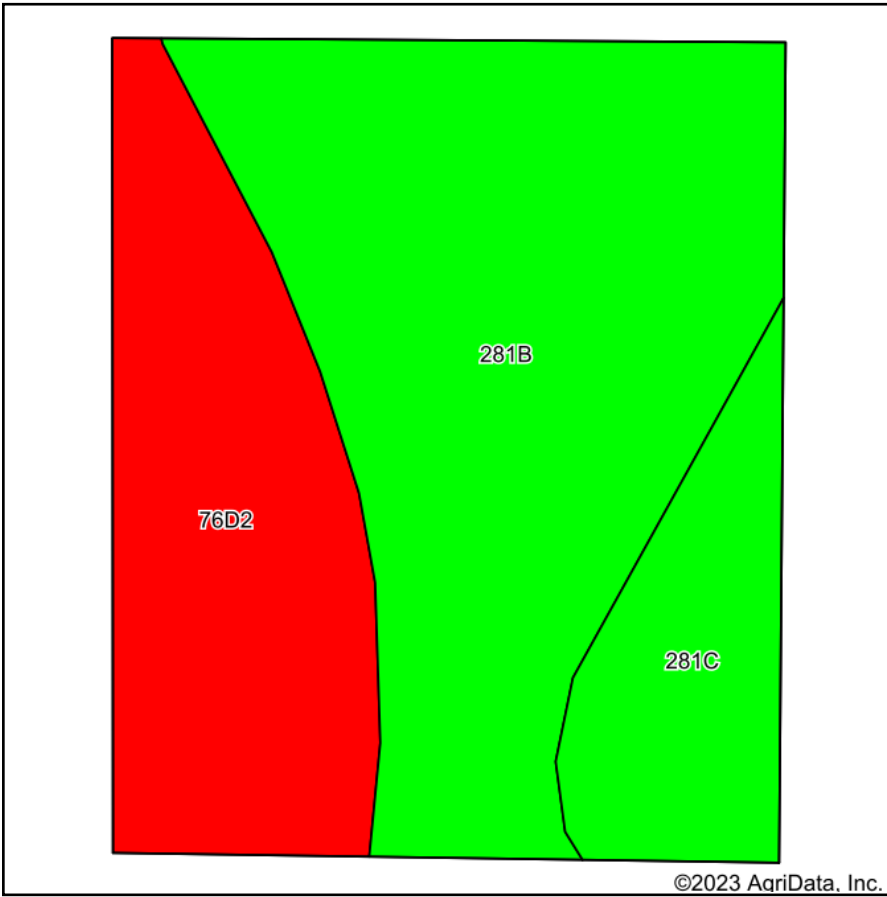

Soils data provided by USDA and NRCS.

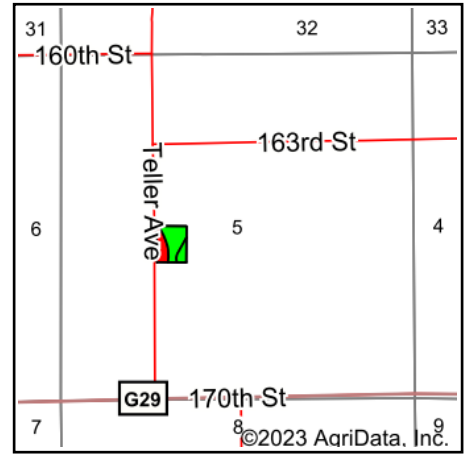

State: **Iowa**  
 County: **Mahaska**  
 Location: **5-76N-14W**  
 Township: **Monroe**  
 Acres: **5.82**  
 Date: **6/21/2023**



Area Symbol: IA123, Soil Area Version: 28

Code	Soil Description	Acres	Percent of field	CSR2 Legend	CSR2**	CSR
281B	Otley silty clay loam, 2 to 5 percent slopes	3.21	55.2%		91	92
76D2	Ladoga silt loam, 9 to 14 percent slopes, eroded	1.77	30.4%		49	58
281C	Otley silty clay loam, 5 to 9 percent slopes	0.84	14.4%		85	77
<b>Weighted Average</b>					<b>77.4</b>	<b>79.5</b>

\*\*IA has updated the CSR values for each county to CSR2.  
 Soils data provided by USDA and NRCS.