

Tillable Soils Map

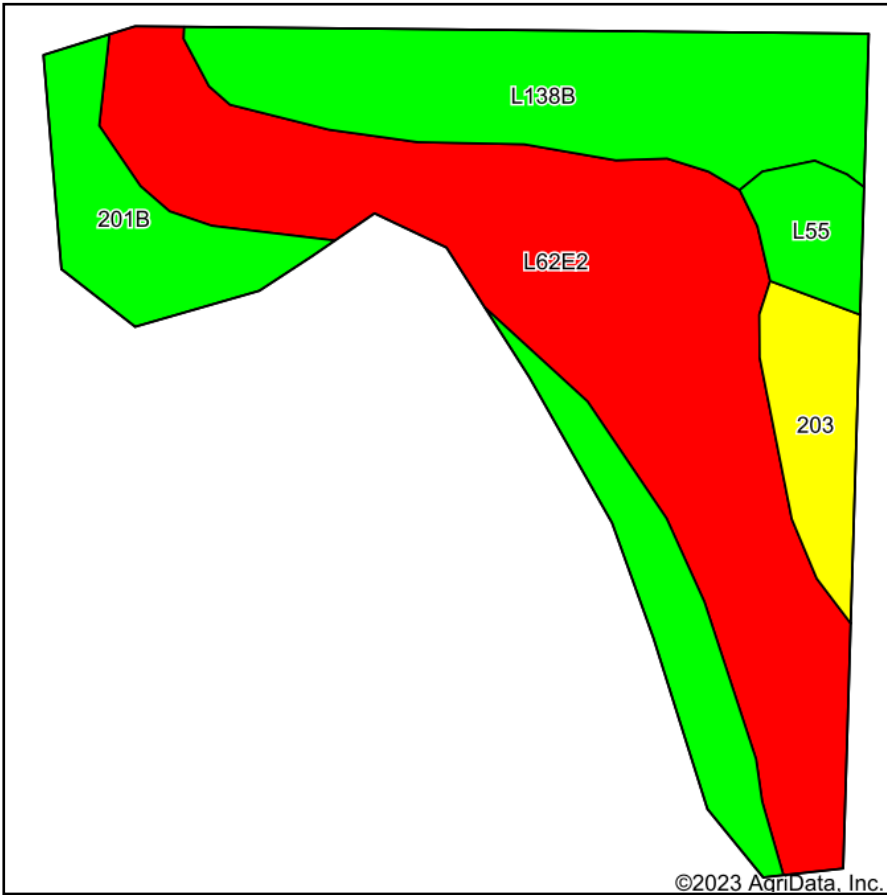

Soils data provided by USDA and NRCS.

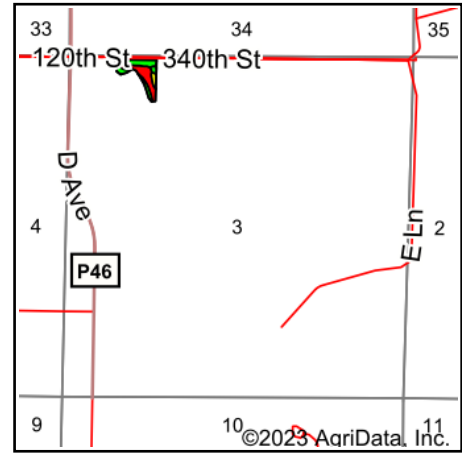

State: **Iowa**
 County: **Dallas**
 Location: **3-81N-29W**
 Township: **Dallas**
 Acres: **4.36**
 Date: **7/17/2023**



Maps Provided By:



© AgriData, Inc. 2023

www.AgriDataInc.com



Area Symbol: IA049, Soil Area Version: 29

Code	Soil Description	Acres	Percent of field	CSR2 Legend	Non-Irr Class *c	*i Corn Bu	*i Soybeans Bu	CSR2**	CSR	*n NCCPI Overall
L62E2	Storden loam, Bemis moraine, 10 to 22 percent slopes, moderately eroded	2.12	48.6%		IVe	0.0	0.0	32		58
L138B	Clarion loam, Bemis moraine, 2 to 6 percent slopes	1.01	23.2%		Ile	80.0	23.2	88		79
201B	Coland-Terril complex, 2 to 5 percent slopes	0.77	17.7%		IIw	208.0	60.3	74	68	83
203	Cylinder loam, 0 to 2 percent slopes	0.29	6.7%		IIs	80.0	23.2	58	80	72
L55	Nicollet loam, 1 to 3 percent slopes	0.17	3.9%		Ie	0.0	0.0	91		84
Weighted Average						2.93	60.6	17.6	56.4	*n 69.2

**IA has updated the CSR values for each county to CSR2.

*. CSR weighted average cannot be calculated on the current soils data, use prior data version for csr values.

*i Yield data provided by the ISPAID Database version 8.1.1 developed by IA State University.

*n: The aggregation method is "Weighted Average using all components"

*c: Using Capabilities Class Dominant Condition Aggregation Method

Soils data provided by USDA and NRCS.