

Soils Map

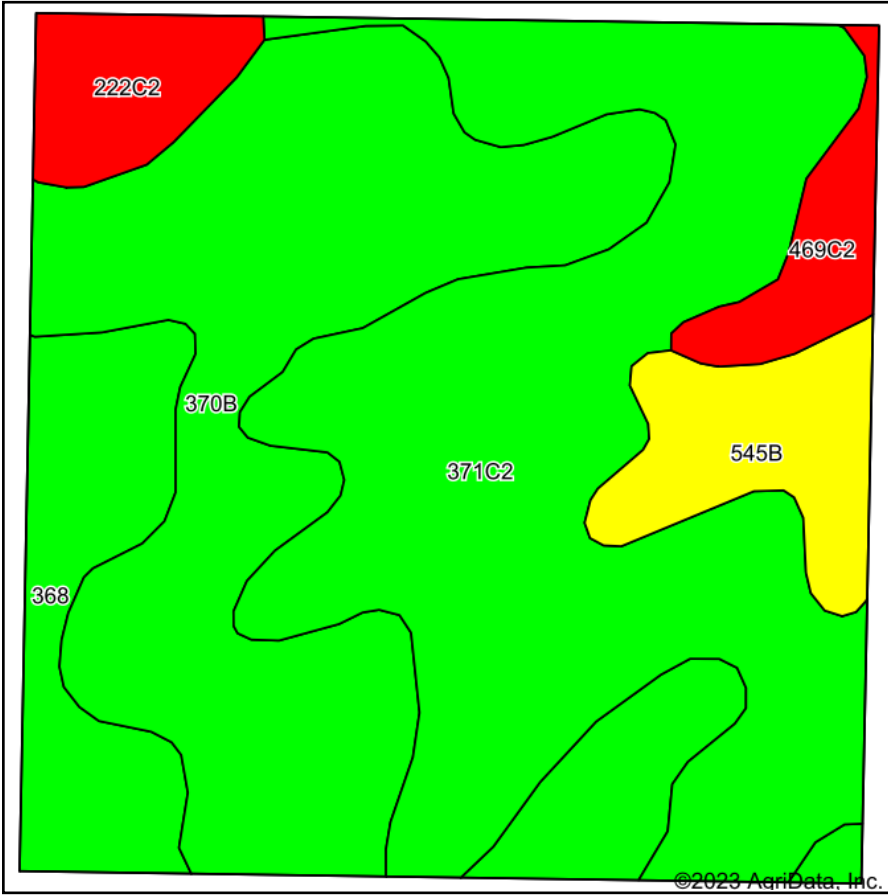

Soils data provided by USDA and NRCS.

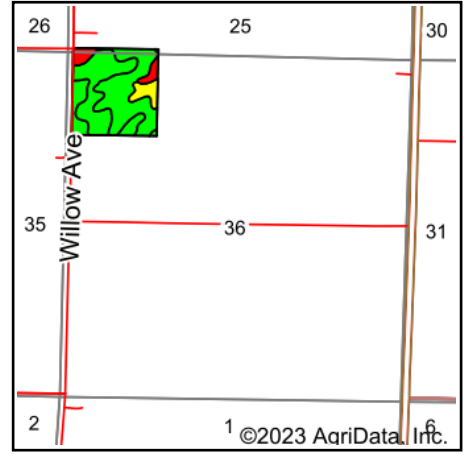

State: **Iowa**
 County: **Adams**
 Location: **36-71N-32W**
 Township: **Grant**
 Acres: **40**
 Date: **7/20/2023**



Maps Provided By:



© AgriData, Inc. 2023

www.AgriDataInc.com



Area Symbol: IA003, Soil Area Version: 34

Code	Soil Description	Acres	Percent of field	CSR2 Legend	Non-Irr Class *c	CSR2**	CSR	*n NCCPI Overall	*n NCCPI Corn	*n NCCPI Small Grains	*n NCCPI Soybeans	
371C2	Sharpsburg-Nira silty clay loams, 5 to 9 percent slopes, eroded	16.35	40.9%		IIIe	83	64	79	79	66	65	
370B	Sharpsburg silty clay loam, 2 to 5 percent slopes	14.52	36.3%		Ile	91	87	92	92	77	79	
368	Macksburg silty clay loam, 0 to 2 percent slopes	3.60	9.0%		Iw	93	95	87	87	78	78	
545B	Zook-Ely-Gullied land complex, 2 to 5 percent slopes	2.55	6.4%		Ile	64	52	9	8	8	8	
222C2	Clarinda silty clay loam, 5 to 9 percent slopes, eroded	1.63	4.1%		IVw	38	25	56	56	49	47	
469C2	Lamoni-Clarinda-Shelby complex, 5 to 9 percent slopes, eroded	1.35	3.4%		IIIe	44	30	62	62	53	48	
Weighted Average						2.43	82.4	71.6	*n 78.5	*n 78.4	*n 66.2	*n 66.3

**IA has updated the CSR values for each county to CSR2.

*n: The aggregation method is "Weighted Average using all components"

*c: Using Capabilities Class Dominant Condition Aggregation Method

Soils data provided by USDA and NRCS.