

# Total Soils Map

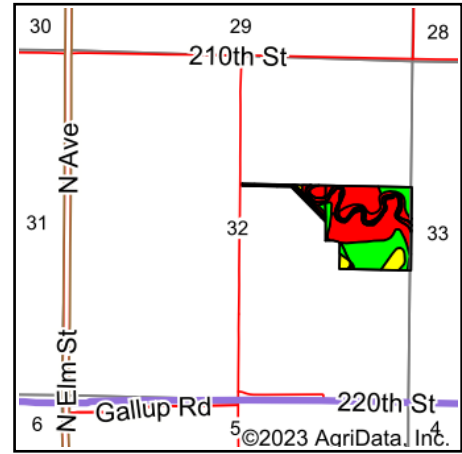

State: **Iowa**  
 County: **Greene**  
 Location: **32-84N-30W**  
 Township: **Hardin**  
 Acres: **40.57**  
 Date: **7/28/2023**

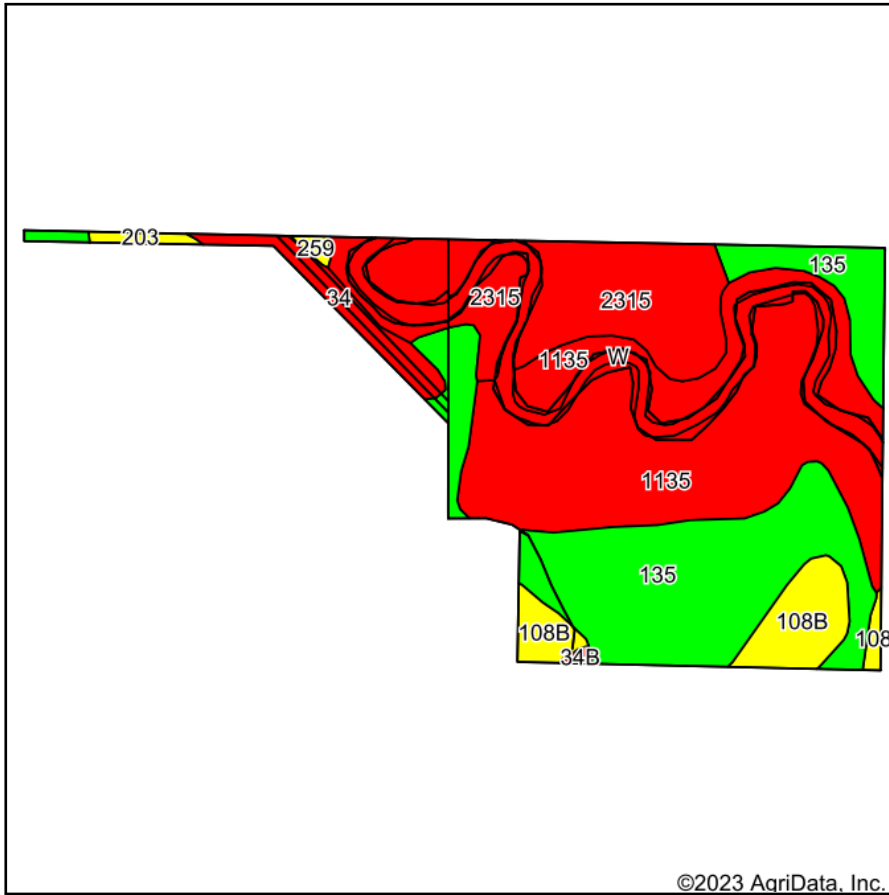

Maps Provided By:



Soils data provided by USDA and NRCS.

©2023 AgriData, Inc.

© AgriData, Inc. 2023

www.AgriDataInc.com

Area Symbol: IA073, Soil Area Version: 28

Code	Soil Description	Acres	Percent of field	CSR2 Legend	Non-Irr Class *c	*i Corn Bu	*i Soybeans Bu	CSR2**	CSR	*n NCCPI Overall	
1135	Coland clay loam, 0 to 2 percent slopes, frequently flooded	14.00	34.5%		Vw	120.0	34.8	13	25	37	
135	Coland clay loam, 0 to 2 percent slopes, occasionally flooded	11.76	29.0%		llw	198.4	57.5	76	81	83	
2315	Fluvaquents-Coland complex, 0 to 3 percent slopes	7.41	18.3%		Vw	88.0	25.5	24	25	28	
W	Water	3.05	7.5%			0.0	0.0	0	0		
108B	Wadena loam, 2 to 6 percent slopes	2.43	6.0%		lle	80.0	23.2	52	51	62	
34	Estherville sandy loam, 0 to 2 percent slopes	1.26	3.1%		lls	80.0	23.2	23	25	48	
203	Cylinder loam, 0 to 2 percent slopes	0.24	0.6%		lls	80.0	23.2	58		72	
108	Wadena loam, 0 to 2 percent slopes	0.20	0.5%		lls	80.0	23.2	56	56	62	
259	Biscay clay loam, 0 to 2 percent slopes	0.15	0.4%		llw	80.0	23.2	52		69	
34B	Estherville sandy loam, 2 to 6 percent slopes	0.07	0.2%		lls	80.0	23.2	27	20	49	
<b>Weighted Average</b>						<b>*-</b>	<b>123.6</b>	<b>35.8</b>	<b>35.6</b>	<b>*-</b>	<b>*n 48.2</b>

\*\*IA has updated the CSR values for each county to CSR2.

\*- CSR weighted average cannot be calculated on the current soils data, use prior data version for csr values.

\*i Yield data provided by the ISPAID Database version 8.1.1 developed by IA State University.

\*n: The aggregation method is "Weighted Average using all components"

\*c: Using Capabilities Class Dominant Condition Aggregation Method

\*- Non Irr Class weighted average cannot be calculated on the current soils data due to missing data.

Soils data provided by USDA and NRCS.