

# Tillable Soils Map

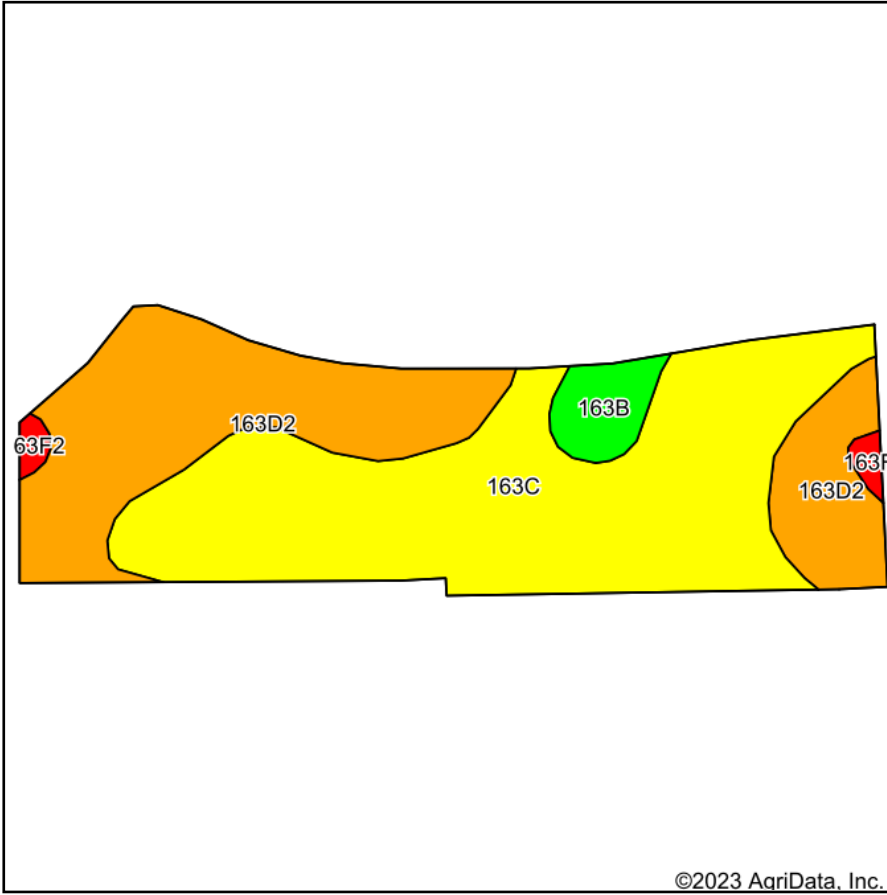

Soils data provided by USDA and NRCS.

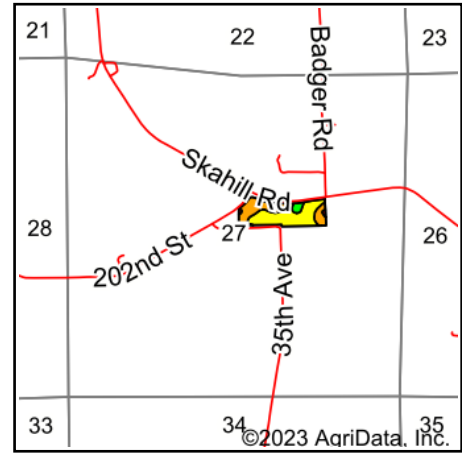

State: **Iowa**  
 County: **Jones**  
 Location: **27-86N-1W**  
 Township: **Washington**  
 Acres: **11.85**  
 Date: **8/3/2023**



Maps Provided By:



Area Symbol: IA105, Soil Area Version: 27

Code	Soil Description	Acres	Percent of field	CSR2 Legend	Non-Irr Class *c	CSR2**	*n NCCPI Overall	
163C	Fayette silt loam, 5 to 9 percent slopes	6.63	55.9%		IIIe	75	86	
163D2	Fayette silt loam, 9 to 14 percent slopes, moderately eroded	4.53	38.2%		IIIe	46	78	
163B	Fayette silt loam, 2 to 6 percent slopes	0.51	4.3%		IIe	83	88	
163F	Fayette silt loam, 18 to 25 percent slopes	0.09	0.8%		VIe	21	62	
163F2	Fayette silt loam, 18 to 25 percent slopes, moderately eroded	0.09	0.8%		VIe	18	59	
<b>Weighted Average</b>						<b>3.00</b>	<b>63.4</b>	<b>*n 82.6</b>

\*\*IA has updated the CSR values for each county to CSR2.

\*n: The aggregation method is "Weighted Average using all components"

\*c: Using Capabilities Class Dominant Condition Aggregation Method

Soils data provided by USDA and NRCS.