

Tillable Soils Map

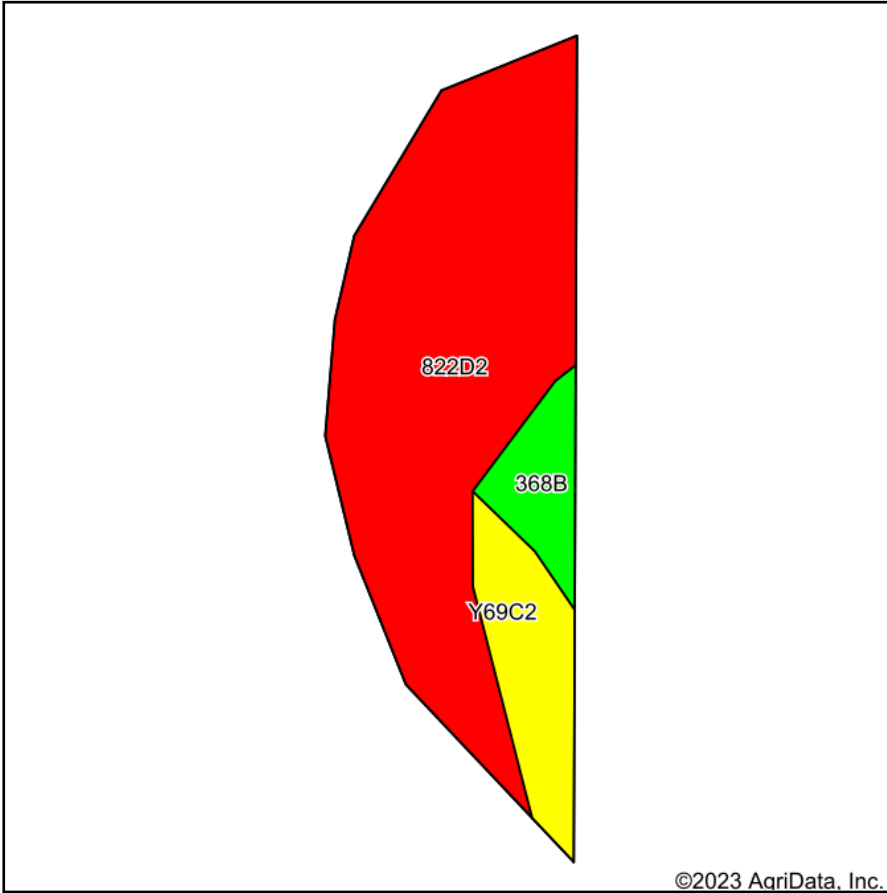

Soils data provided by USDA and NRCS.

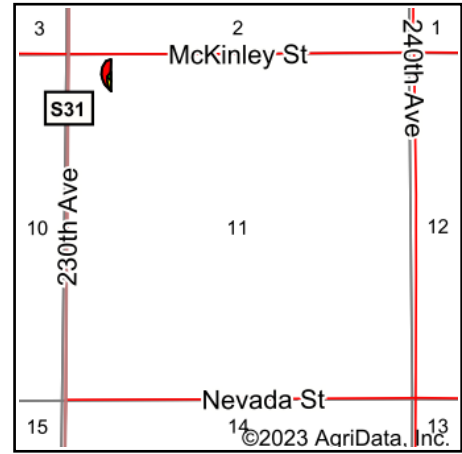

State: **Iowa**
 County: **Warren**
 Location: **11-75N-22W**
 Township: **Belmont**
 Acres: **1.18**
 Date: **8/8/2023**



Maps Provided By:



© AgriData, Inc. 2023

www.AgriDataInc.com



Area Symbol: IA181, Soil Area Version: 28

Code	Soil Description	Acres	Percent of field	CSR2 Legend	Non-Irr Class *c	CSR2**	CSR	*n NCCPI Overall	*n NCCPI Corn	*n NCCPI Small Grains	*n NCCPI Soybeans	
822D2	Lamoni silty clay loam, 9 to 14 percent slopes, eroded	0.90	76.3%		IVe	10	15	59	59	54	42	
Y69C2	Clearfield silty clay loam, dissected till plain, 5 to 9 percent slopes, eroded	0.18	15.3%		IIIw	56		66	66	64	59	
368B	Macksburg silty clay loam, 2 to 5 percent slopes	0.10	8.5%		Ile	89	90	87	87	79	78	
Weighted Average						3.68	23.7	*-	*n 62.4	*n 62.4	*n 57.6	*n 47.6

**IA has updated the CSR values for each county to CSR2.

*- CSR weighted average cannot be calculated on the current soils data, use prior data version for csr values.

*n: The aggregation method is "Weighted Average using all components"

*c: Using Capabilities Class Dominant Condition Aggregation Method

Soils data provided by USDA and NRCS.