

Soils Map

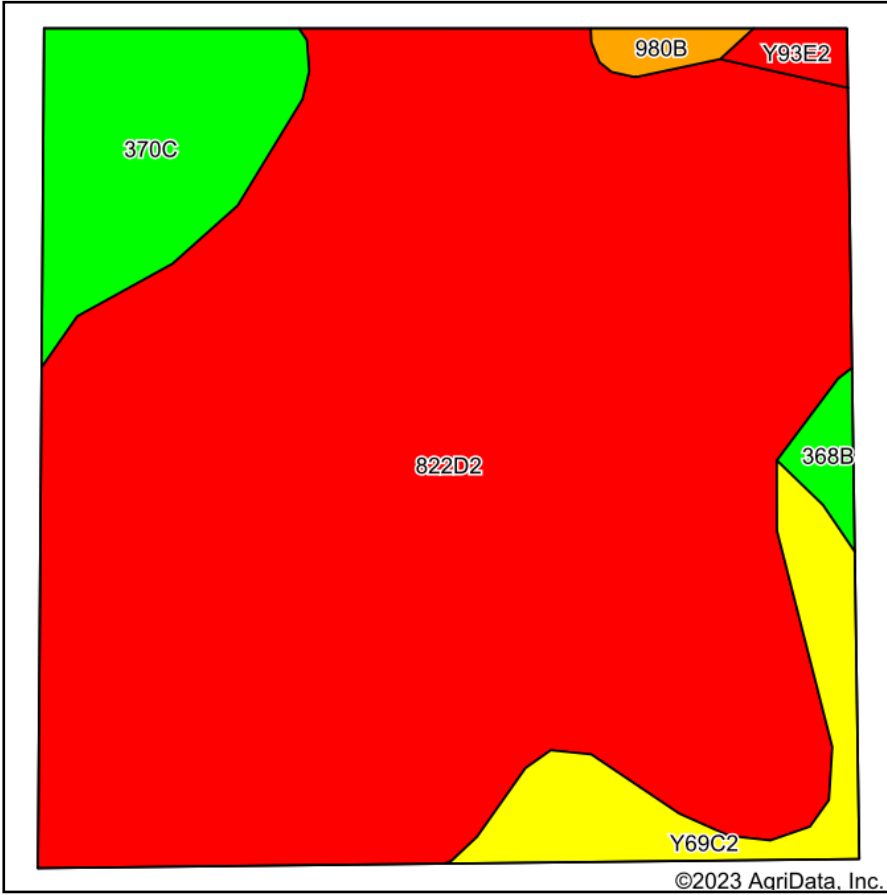

Soils data provided by USDA and NRCS.

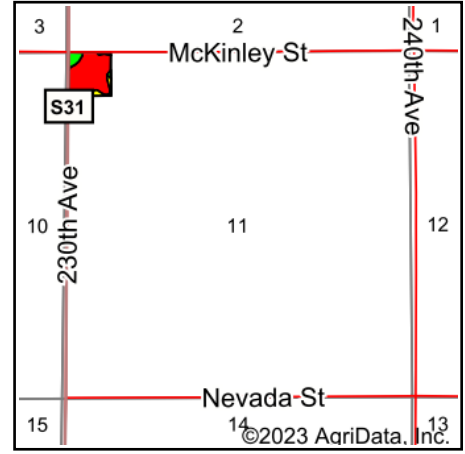

State: **Iowa**
 County: **Warren**
 Location: **11-75N-22W**
 Township: **Belmont**
 Acres: **10**
 Date: **8/8/2023**



Maps Provided By:



© AgriData, Inc. 2023

www.AgriDataInc.com



Area Symbol: IA181, Soil Area Version: 28

Code	Soil Description	Acres	Percent of field	CSR2 Legend	Non-Irr Class *c	CSR2**	CSR	*n NCCPI Overall	*n NCCPI Corn	*n NCCPI Small Grains	*n NCCPI Soybeans	
822D2	Lamoni silty clay loam, 9 to 14 percent slopes, eroded	8.32	83.2%		IVe	10	15	59	59	54	42	
370C	Sharpsburg silty clay loam, 5 to 9 percent slopes	0.85	8.5%		IIIe	81	72	89	89	76	75	
Y69C2	Clearfield silty clay loam, dissected till plain, 5 to 9 percent slopes, eroded	0.57	5.7%		IIIw	56		66	66	64	59	
368B	Macksburg silty clay loam, 2 to 5 percent slopes	0.10	1.0%		Ile	89	90	87	87	79	78	
Y93E2	Shelby-Adair clay loams, dissected till plain, 14 to 18 percent slopes, eroded	0.08	0.8%		IVe	28		60	60	47	42	
980B	Gullied land-Ely-Colo, occasionally flooded, complex, 2 to 5 percent slopes	0.08	0.8%		VIIe	42	25	10	10	9	9	
Weighted Average						3.86	19.8	*	*n 61.8	*n 61.8	*n 56.3	*n 45.9

**IA has updated the CSR values for each county to CSR2.

*- CSR weighted average cannot be calculated on the current soils data, use prior data version for csr values.

*n: The aggregation method is "Weighted Average using all components"

*c: Using Capabilities Class Dominant Condition Aggregation Method

Soils data provided by USDA and NRCS.