

Soils Map

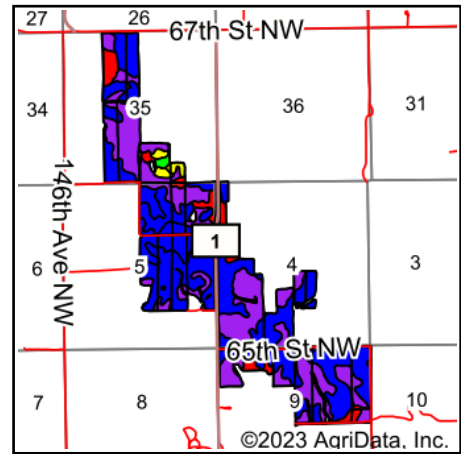

State: **North Dakota**
 County: **Williams**
 Location: **4-156N-102W**
 Township: **Cow Creek**
 Acres: **842.9**
 Date: **8/17/2023**

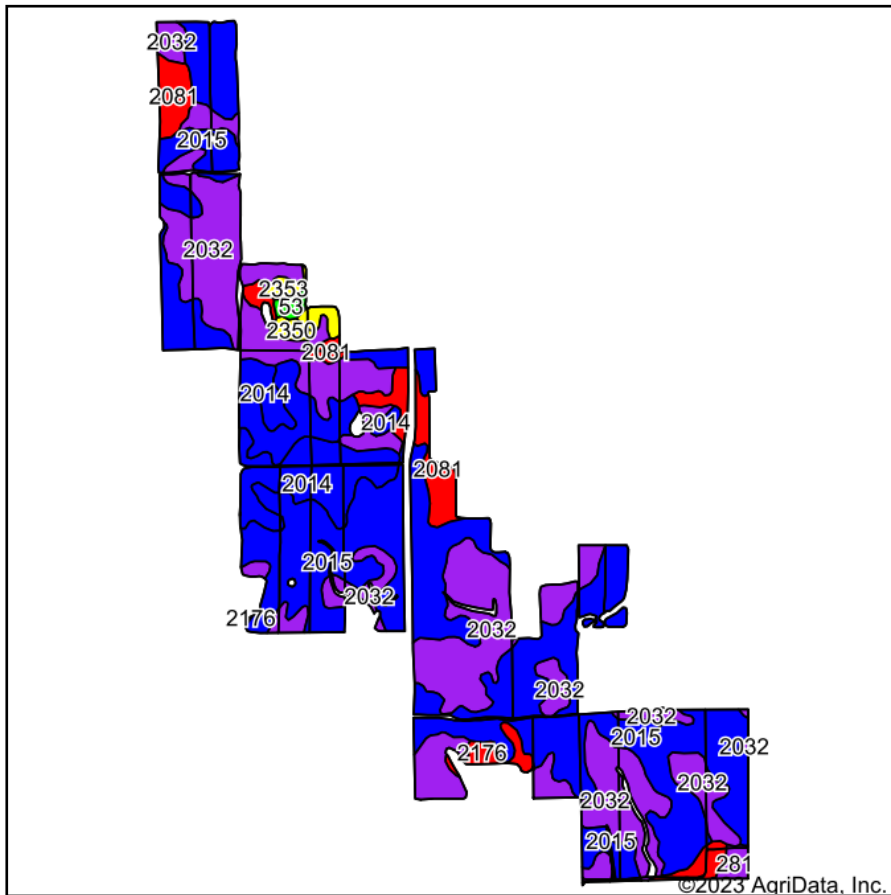

Maps Provided By:



Soils data provided by USDA and NRCS.

Area Symbol: ND105, Soil Area Version: 22

Code	Soil Description	Acres	Percent of field	PI Legend	Non-Irr Class *c	Irr Class *c	Range Production (lbs/acre/yr)	Productivity Index	*n NCCPI Overall	*n NCCPI Corn	*n NCCPI Small Grains	*n NCCPI Soybeans
2015	Williams-Bowbells loams, 3 to 6 percent slopes	406.80	48.3%		Ile		2588	85	20	5	19	19
2032	Vida-Zahill loams, 2 to 8 percent slopes	293.50	34.8%		IIle	IIle	1286	57	17	4	15	17
2014	Williams-Bowbells loams, 0 to 3 percent slopes	63.41	7.5%		IIc		2377	90	20	5	19	20
2081	Zahill-Vida loams, 4 to 15 percent slopes	39.33	4.7%		IVe		1167	35	16	4	14	16
2176	Zahill loam, 15 to 60 percent slopes	8.13	1.0%		VIIe		932	19	5	1	4	3
1249	Appam sandy loam, 0 to 6 percent slopes	7.04	0.8%		IIIe		2275	41	14	3	14	7
2358	Tally fine sandy loam, 0 to 6 percent slopes	5.20	0.6%		IIIe		2394	62	16	4	16	14
281	Bowdle loam, 0 to 2 percent slopes	4.87	0.6%		IIs		2170	57	16	4	16	12
2350	Lehr-Williams loams, 0 to 6 percent slopes	4.20	0.5%		IIIe		1367	64	17	4	17	14
53	Arnegard loam, 0 to 2 percent slopes	3.63	0.4%		IIc		2427	95	20	5	20	19
2353	Livona fine sandy loam, 0 to 6 percent slopes	3.41	0.4%		IIIe		2342	68	19	5	19	18
1835	Nishon clay loam, 0 to 1 percent slopes	3.38	0.4%		IIIw	IIIw	3840	43	13	2	13	5
Weighted Average					2.52	*-	2027.5	71.7	*n 18.5	*n 4.5	*n 17.1	*n 17.8

*n: The aggregation method is "Weighted Average using all components"

*c: Using Capabilities Class Dominant Condition Aggregation Method

*- Irr Class weighted average cannot be calculated on the current soils data due to missing data.

Soils data provided by USDA and NRCS.