

Soils Map

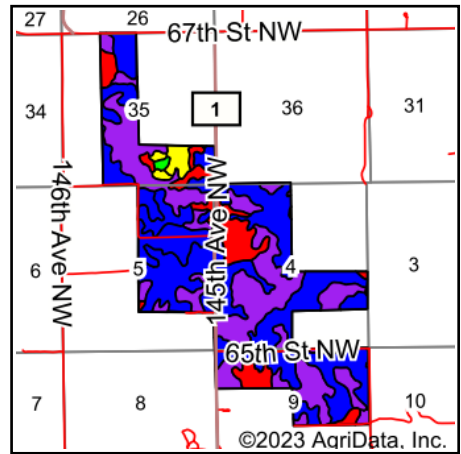

State: **North Dakota**
 County: **Williams**
 Location: **4-156N-102W**
 Township: **Cow Creek**
 Acres: **1178.03**
 Date: **8/16/2023**

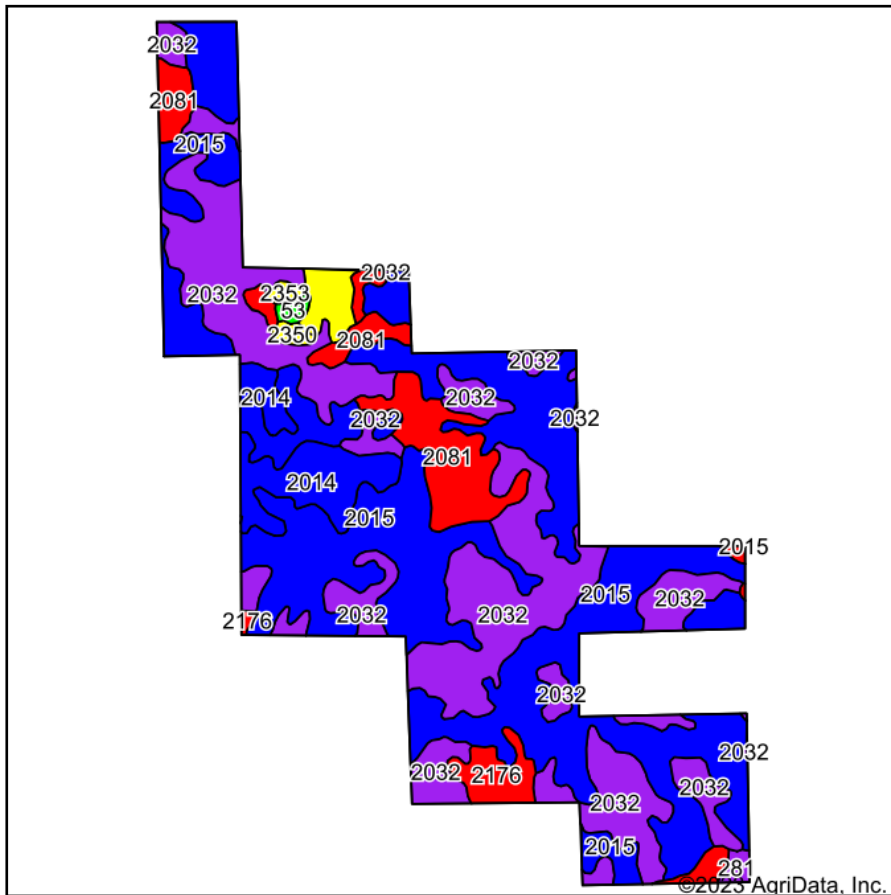

Maps Provided By:

 CUSTOMIZED ONLINE MAPPING
 © AgriData, Inc. 2023 www.AgriDataInc.com



Soils data provided by USDA and NRCS.

Area Symbol: ND105, Soil Area Version: 22

Code	Soil Description	Acres	Percent of field	PI Legend	Non-Irr Class *c	Irr Class *c	Range Production (lbs/acre/yr)	Productivity Index	*n NCCPI Overall	*n NCCPI Corn	*n NCCPI Small Grains	*n NCCPI Soybeans
2015	Williams-Bowbells loams, 3 to 6 percent slopes	557.70	47.3%		Ile		2588	85	20	5	19	19
2032	Vida-Zahill loams, 2 to 8 percent slopes	396.38	33.6%		IIle	IIle	1286	57	17	4	15	17
2081	Zahill-Vida loams, 4 to 15 percent slopes	83.71	7.1%		IVe		1167	35	16	4	14	16
2014	Williams-Bowbells loams, 0 to 3 percent slopes	65.29	5.5%		Ilc		2377	90	20	5	19	20
2176	Zahill loam, 15 to 60 percent slopes	25.49	2.2%		VIIe		932	19	5	1	4	3
2358	Tally fine sandy loam, 0 to 6 percent slopes	17.54	1.5%		IIle		2394	62	16	4	16	14
1249	Appam sandy loam, 0 to 6 percent slopes	6.66	0.6%		IIle		2275	41	14	3	14	7
1798	Tally fine sandy loam, 6 to 9 percent slopes	4.93	0.4%		IVe		2335	50	17	4	17	14
281	Bowdle loam, 0 to 2 percent slopes	4.58	0.4%		IIs		2170	57	16	4	16	12
2350	Lehr-Williams loams, 0 to 6 percent slopes	4.29	0.4%		IIle		1367	64	17	4	17	14
1835	Nishon clay loam, 0 to 1 percent slopes	4.25	0.4%		IIIw	IIIw	3840	43	13	2	13	5
53	Arnegard loam, 0 to 2 percent slopes	3.80	0.3%		Ilc		2427	95	20	5	20	19
2353	Livona fine sandy loam, 0 to 6 percent slopes	3.41	0.3%		IIle		2342	68	19	5	19	18



Weighted Average	2.63	*-	1992.9	69.8	*n 18.2	*n 4.5	*n 16.9	*n 17.6
-------------------------	-------------	-----------	---------------	-------------	----------------	---------------	----------------	----------------

*n: The aggregation method is "Weighted Average using all components"

*c: Using Capabilities Class Dominant Condition Aggregation Method

*- Irr Class weighted average cannot be calculated on the current soils data due to missing data.

Soils data provided by USDA and NRCS.