

Soils Map

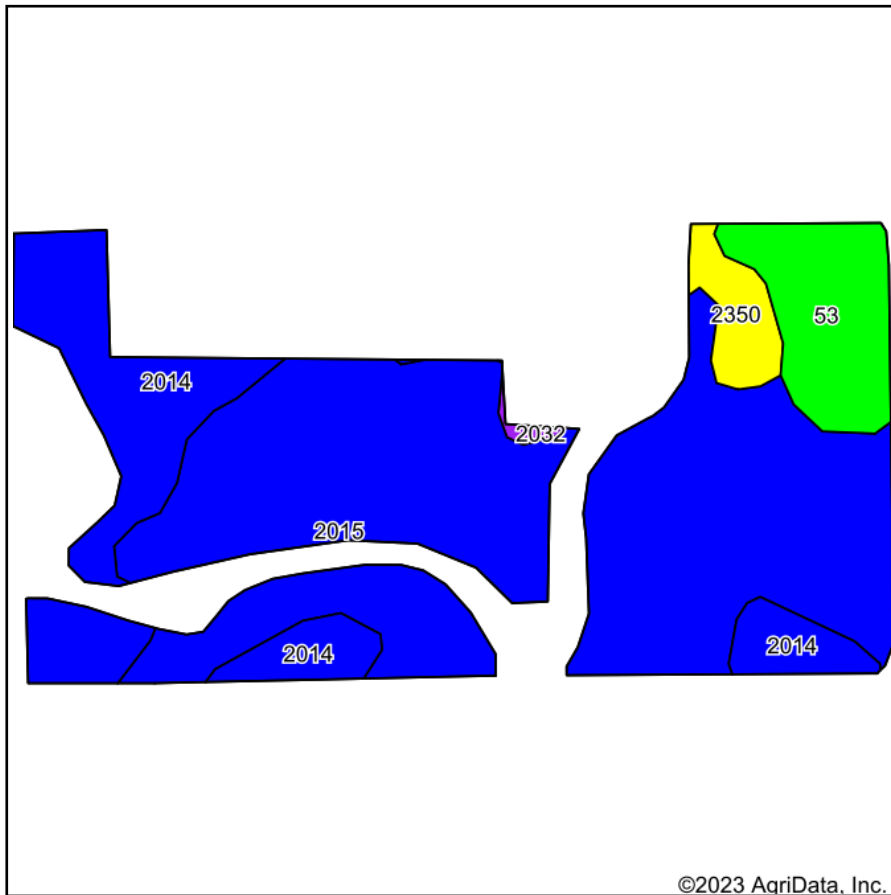

Soils data provided by USDA and NRCS.

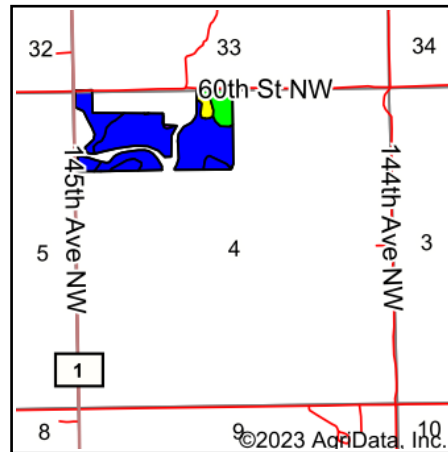

State: **North Dakota**
 County: **Williams**
 Location: **4-15N-102W**
 Township: **Mont**
 Acres: **53.18**
 Date: **8/15/2023**



Maps Provided By:



© AgriData, Inc. 2023

www.AgriDataInc.com



Area Symbol: ND105, Soil Area Version: 22

Code	Soil Description	Acres	Percent of field	PI Legend	Non-Irr Class *c	Irr Class *c	Range Production (lbs/acre/yr)	Productivity Index	*n NCCPI Overall	*n NCCPI Corn	*n NCCPI Small Grains	*n NCCPI Soybeans
2015	Williams-Bowbells loams, 3 to 6 percent slopes	34.75	65.3%		Ile		2588	85	20	5	19	19
2014	Williams-Bowbells loams, 0 to 3 percent slopes	11.21	21.1%		IIc		2377	90	20	5	19	20
53	Arnegard loam, 0 to 2 percent slopes	5.11	9.6%		IIc		2427	95	20	5	20	19
2350	Lehr-Williams loams, 0 to 6 percent slopes	1.90	3.6%		IIIe		1367	64	17	4	17	14
2032	Vida-Zahill loams, 2 to 8 percent slopes	0.21	0.4%		IIIe	IIIe	1286	57	17	4	15	17
Weighted Average					2.04	*-	2479.3	86.2	*n 19.9	*n 5	*n 19	*n 19

*n: The aggregation method is "Weighted Average using all components"

*c: Using Capabilities Class Dominant Condition Aggregation Method

*- Irr Class weighted average cannot be calculated on the current soils data due to missing data.

Soils data provided by USDA and NRCS.