

# Tract 1 - Estimated Current Tillable Soils Map

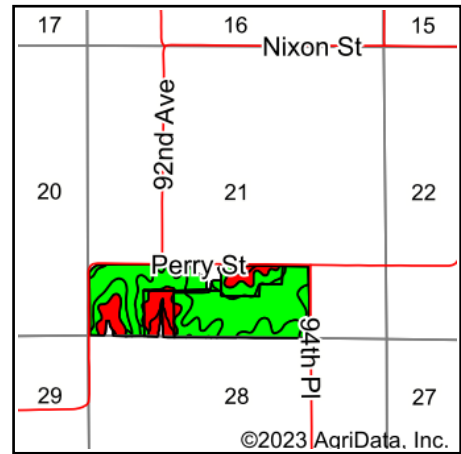

State: **Iowa**  
 County: **Marion**  
 Location: **21-75N-20W**  
 Township: **Knoxville**  
 Acres: **113.74**  
 Date: **8/23/2023**

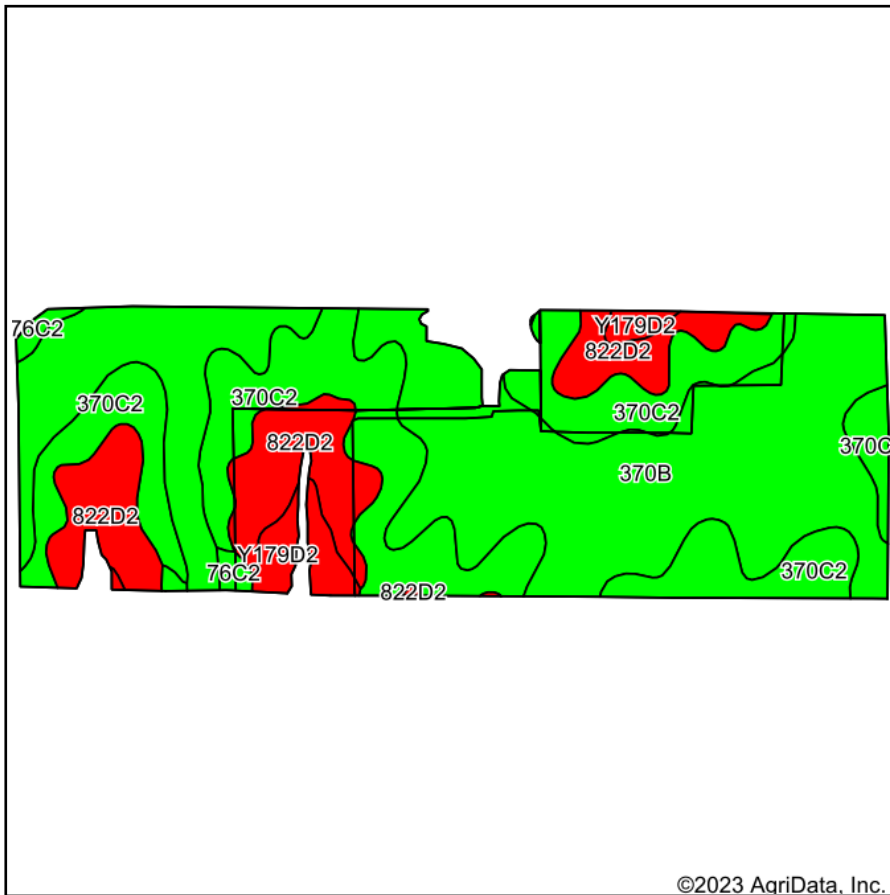

Maps Provided By:



Soils data provided by USDA and NRCS.

©2023 AgriData, Inc.

© AgriData, Inc. 2023

www.AgriDataInc.com

Area Symbol: IA125, Soil Area Version: 32

Code	Soil Description	Acres	Percent of field	CSR2 Legend	Non-Irr Class *c	CSR2**	CSR	*n NCCPI Overall	*n NCCPI Corn	*n NCCPI Small Grains	*n NCCPI Soybeans
370B	Sharpsburg silty clay loam, 2 to 5 percent slopes	54.53	47.9%		Ile	91	87	92	92	77	79
370C2	Sharpsburg silty clay loam, 5 to 9 percent slopes, eroded	37.12	32.6%		IIle	80	67	82	82	68	65
822D2	Lamoni silty clay loam, 9 to 14 percent slopes, moderately eroded	17.02	15.0%		IVe	10	15	63	63	59	49
Y179D2	Gara loam, dissected till plain, 9 to 14 percent slopes, eroded	3.73	3.3%		IVe	43		73	73	56	52
76C2	Ladoga silt loam, 5 to 9 percent slopes, eroded	1.34	1.2%		IIIe	75	65	86	86	67	67
<b>Weighted Average</b>						<b>2.70</b>	<b>73.5</b>	<b>*n 83.7</b>	<b>*n 83.7</b>	<b>*n 70.6</b>	<b>*n 68.9</b>

\*\*IA has updated the CSR values for each county to CSR2.

\*- CSR weighted average cannot be calculated on the current soils data, use prior data version for csr values.

\*n: The aggregation method is "Weighted Average using all components"

\*c: Using Capabilities Class Dominant Condition Aggregation Method

Soils data provided by USDA and NRCS.