

Tillable Soils Map

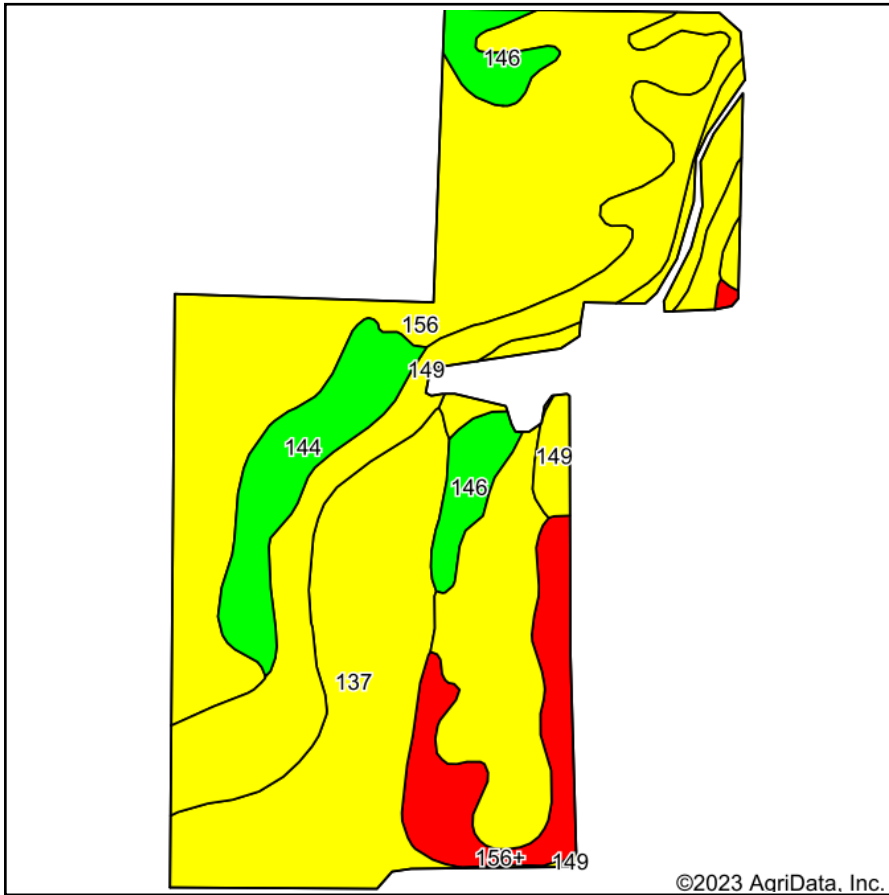

Soils data provided by USDA and NRCS.

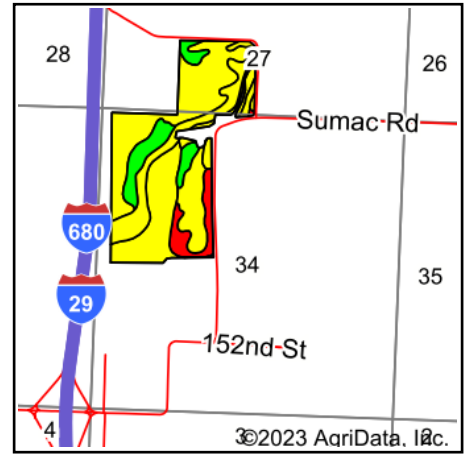

State: **Iowa**
 County: **Pottawattamie**
 Location: **34-77N-44W**
 Township: **Rockford**
 Acres: **139.72**
 Date: **8/31/2023**



Maps Provided By:



© AgriData, Inc. 2023

www.AgriDataInc.com



Area Symbol: IA155, Soil Area Version: 28

Code	Soil Description	Acres	Percent of field	CSR2 Legend	Non-Irr Class *c	Irr Class *c	*i Corn Bu	*i Soybeans Bu	CSR2**	CSR	*n NCCPI Overall
156	Albaton silty clay, 0 to 2 percent slopes, occasionally flooded	62.80	44.9%	Yellow	IIIw	IIIw	161.6	46.9	52	55	51
137	Haynie silt loam, 0 to 2 percent slopes, occasionally flooded	27.34	19.6%	Yellow	IIw	IIw	195.2	56.6	67	70	78
149	Modale silt loam, 0 to 2 percent slopes	23.82	17.0%	Yellow	Iw		208.0	60.3	69	68	64
156+	Albaton silt loam, 0 to 2 percent slopes, overwash, occasionally flooded	10.08	7.2%	Red	IIIw		80.0	23.2	29	58	53
144	Blake silty clay loam, 0 to 2 percent slopes	9.51	6.8%	Green	Iw	Iw	230.4	66.8	86	75	83
146	Onawa silty clay, 0 to 2 percent slopes	6.17	4.4%	Green	IIw	IIw	201.6	58.5	79	65	60
Weighted Average							176.6	51.2	59.7	62.2	*n 61.2

**IA has updated the CSR values for each county to CSR2.

*i Yield data provided by the ISPAID Database version 8.1.1 developed by IA State University.

*n: The aggregation method is "Weighted Average using all components"

*c: Using Capabilities Class Dominant Condition Aggregation Method

*- Irr Class weighted average cannot be calculated on the current soils data due to missing data.

Soils data provided by USDA and NRCS.