

# Total Soils Map

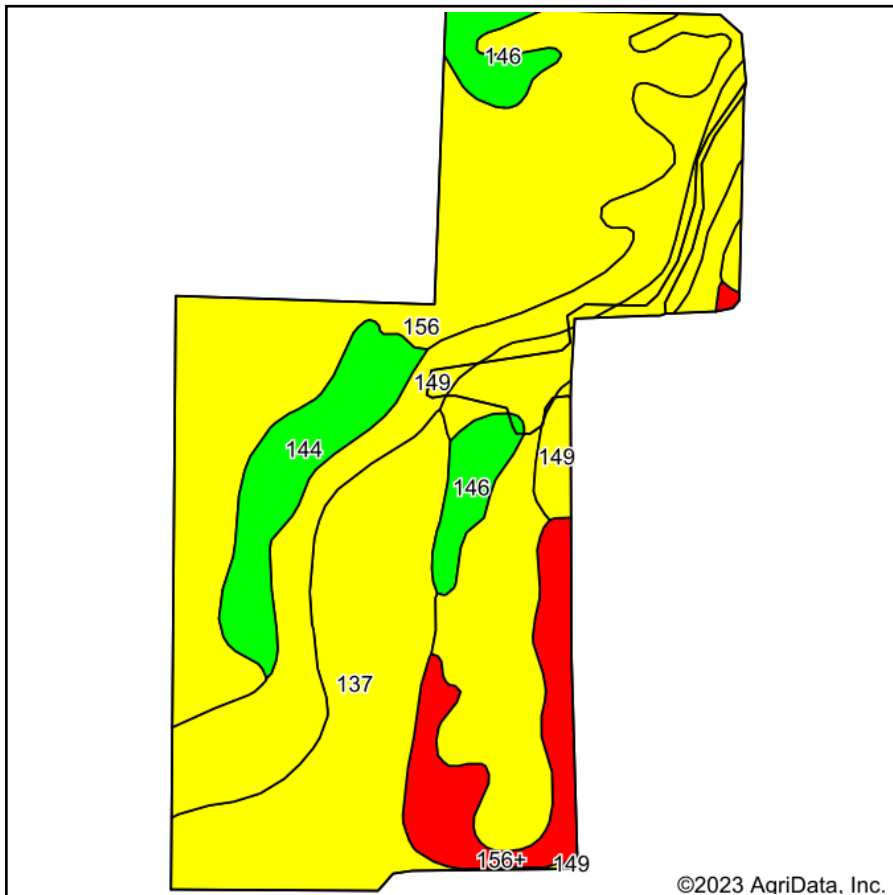

Soils data provided by USDA and NRCS.

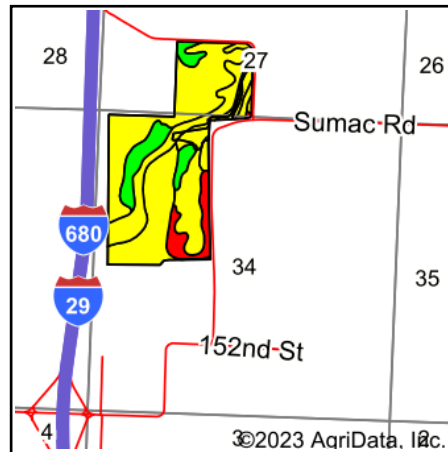

State: **Iowa**  
 County: **Pottawattamie**  
 Location: **34-77N-44W**  
 Township: **Rockford**  
 Acres: **144.14**  
 Date: **8/31/2023**



Maps Provided By:



Area Symbol: IA155, Soil Area Version: 28

Code	Soil Description	Acres	Percent of field	CSR2 Legend	Non-Irr Class *c	Irr Class *c	*i Corn Bu	*i Soybeans Bu	CSR2**	CSR	*n NCCPI Overall		
156	Albaton silty clay, 0 to 2 percent slopes, occasionally flooded	66.48	46.1%	Yellow	IIIw	IIIw	161.6	46.9	52	55	51		
137	Haynie silt loam, 0 to 2 percent slopes, occasionally flooded	27.34	19.0%	Yellow	IIw	IIw	195.2	56.6	67	70	78		
149	Modale silt loam, 0 to 2 percent slopes	24.37	16.9%	Yellow	Iw		208.0	60.3	69	68	64		
156+	Albaton silt loam, 0 to 2 percent slopes, overwash, occasionally flooded	10.08	7.0%	Red	IIIw		80.0	23.2	29	58	53		
144	Blake silty clay loam, 0 to 2 percent slopes	9.51	6.6%	Green	Iw	Iw	230.4	66.8	86	75	83		
146	Onawa silty clay, 0 to 2 percent slopes	6.36	4.4%	Green	IIw	IIw	201.6	58.5	79	65	60		
<b>Weighted Average</b>							<b>2.30</b>	<b>*-</b>	<b>176.4</b>	<b>51.2</b>	<b>59.5</b>	<b>62</b>	<b>*n 61</b>

\*\*IA has updated the CSR values for each county to CSR2.

\*i Yield data provided by the ISPAID Database version 8.1.1 developed by IA State University.

\*n: The aggregation method is "Weighted Average using all components"

\*c: Using Capabilities Class Dominant Condition Aggregation Method

\*- Irr Class weighted average cannot be calculated on the current soils data due to missing data.

Soils data provided by USDA and NRCS.