

Tract 1 - Total Soils Map

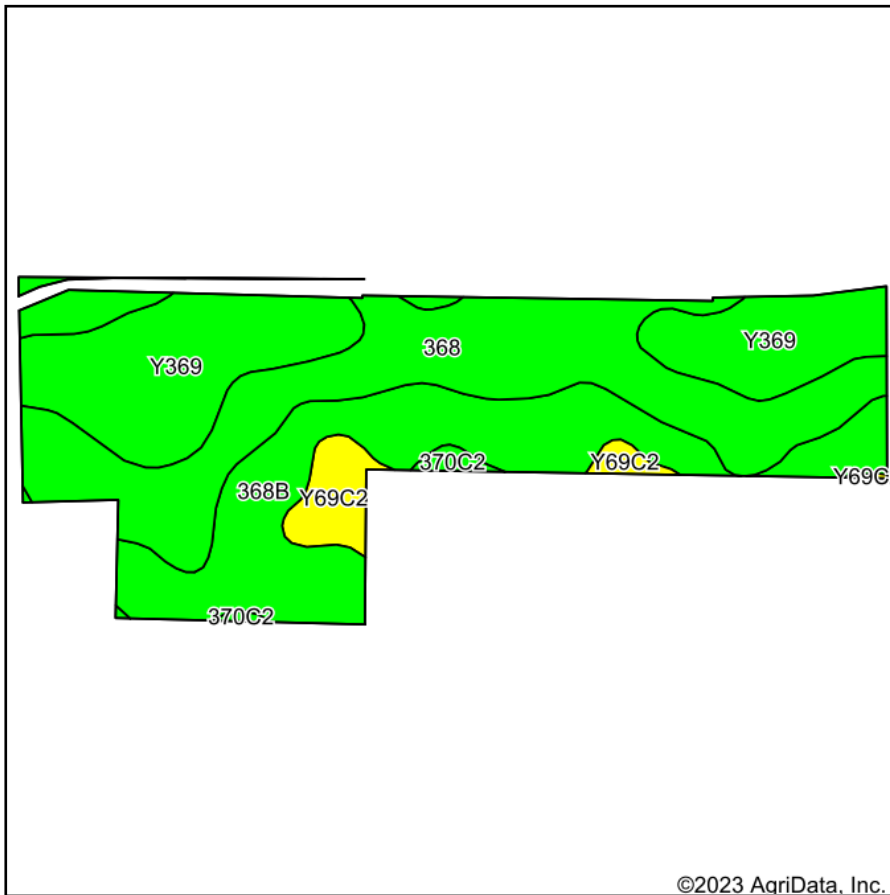

Soils data provided by USDA and NRCS.

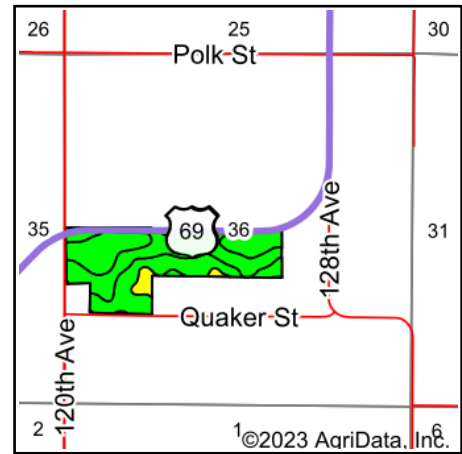

State: **Iowa**
 County: **Warren**
 Location: **36-75N-24W**
 Township: **White Oak**
 Acres: **64.2**
 Date: **9/26/2023**



Maps Provided By:



© AgriData, Inc. 2023

www.AgriDataInc.com



Area Symbol: IA181, Soil Area Version: 28

Code	Soil Description	Acres	Percent of field	CSR2 Legend	Non-Irr Class *c	CSR2**	CSR	*n NCCPI Overall	*n NCCPI Corn	*n NCCPI Small Grains	*n NCCPI Soybeans
368	Macksburg silty clay loam, 0 to 2 percent slopes	24.13	37.6%		Iw	93	95	87	87	78	78
368B	Macksburg silty clay loam, 2 to 5 percent slopes	18.68	29.1%		IIe	89	90	87	87	79	78
Y369	Winterset silty clay loam, 0 to 2 percent slopes	17.75	27.6%		IIw	83		78	77	73	71
Y69C2	Clearfield silty clay loam, dissected till plain, 5 to 9 percent slopes, eroded	3.03	4.7%		IIIw	56		66	66	64	59
370C2	Sharpsburg silty clay loam, 5 to 9 percent slopes, eroded	0.61	1.0%		IIIe	80	67	82	82	68	65
Weighted Average						1.68	87.2	*n 83.5	*n 83.2	*n 76.2	*n 75

**IA has updated the CSR values for each county to CSR2.

*- CSR weighted average cannot be calculated on the current soils data, use prior data version for csr values.

*n: The aggregation method is "Weighted Average using all components"

*c: Using Capabilities Class Dominant Condition Aggregation Method

Soils data provided by USDA and NRCS.