

Tract 4 - Tillable Soils Map

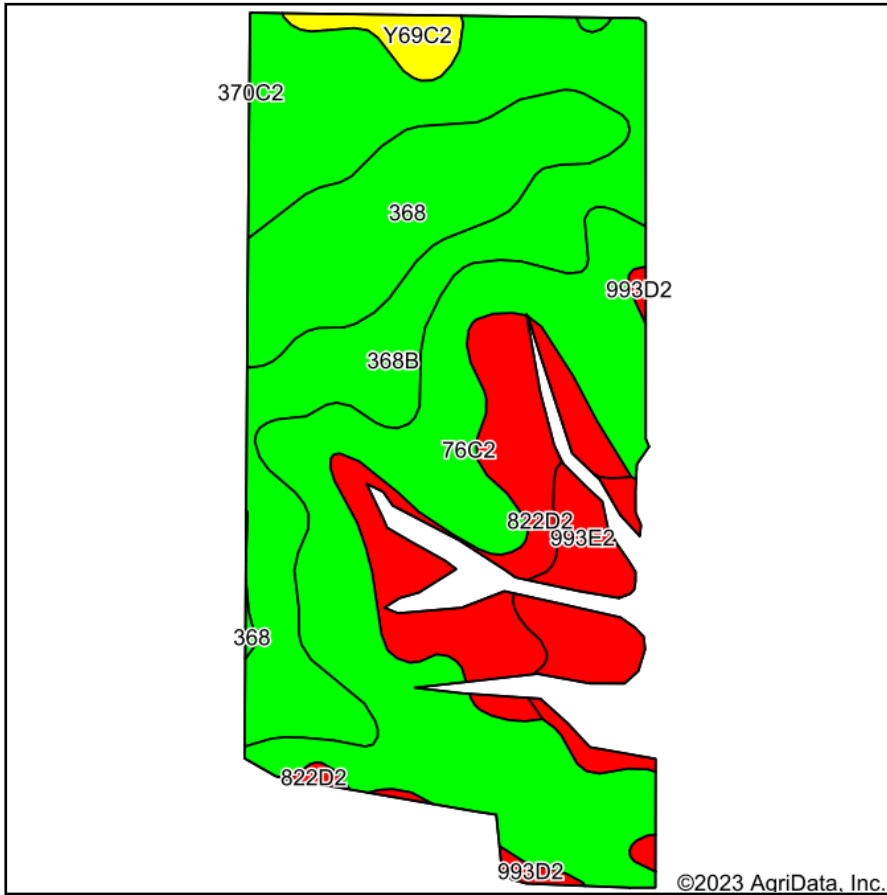

Soils data provided by USDA and NRCS.

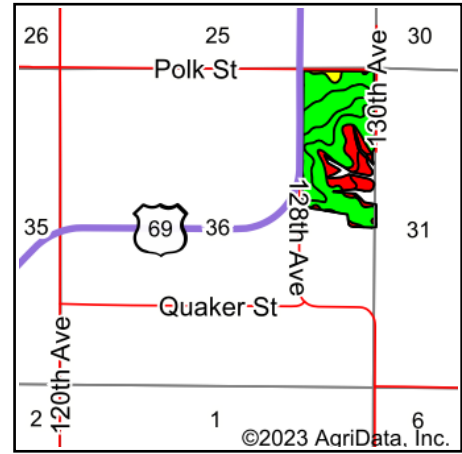

State: **Iowa**
 County: **Warren**
 Location: **36-75N-24W**
 Township: **White Oak**
 Acres: **63.56**
 Date: **9/26/2023**



Maps Provided By:



Area Symbol: IA181, Soil Area Version: 28

Code	Soil Description	Acres	Percent of field	CSR2 Legend	Non-Irr Class *c	CSR2**	CSR	*n NCCPI Overall	*n NCCPI Corn	*n NCCPI Small Grains	*n NCCPI Soybeans	
76C2	Ladoga silt loam, dissected till plain, 5 to 9 percent slopes, eroded	21.07	33.1%		IIIe	75	65	75	75	68	64	
368B	Macksburg silty clay loam, 2 to 5 percent slopes	19.64	30.9%		Ile	89	90	87	87	79	78	
368	Macksburg silty clay loam, 0 to 2 percent slopes	9.07	14.3%		Iw	93	95	87	87	78	78	
822D2	Lamoni silty clay loam, 9 to 14 percent slopes, eroded	8.15	12.8%		IVe	10	15	59	59	54	42	
993E2	Armstrong-Gara loams, 14 to 18 percent slopes, moderately eroded	3.99	6.3%		VIe	17	5	62	62	44	42	
Y69C2	Clearfield silty clay loam, dissected till plain, 5 to 9 percent slopes, eroded	1.22	1.9%		IIIw	56		66	66	64	59	
993D2	Armstrong-Gara loams, 9 to 14 percent slopes, moderately eroded	0.42	0.7%		IVe	23	20	66	66	52	47	
Weighted Average						2.73	69.2	*	*n 77.3	*n 77.3	*n 69.3	*n 65.9

**IA has updated the CSR values for each county to CSR2.

*- CSR weighted average cannot be calculated on the current soils data, use prior data version for csr values.

*n: The aggregation method is "Weighted Average using all components"

*c: Using Capabilities Class Dominant Condition Aggregation Method

Soils data provided by USDA and NRCS.