

Tract 7 - Total Soils Map

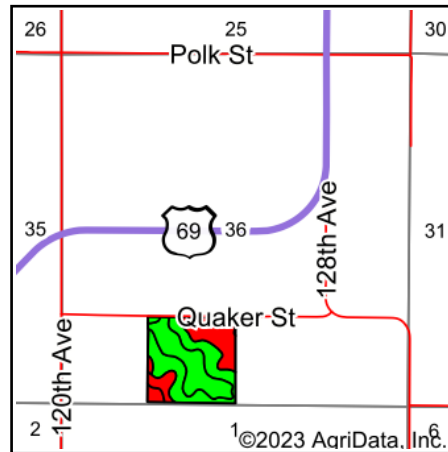

State: **Iowa**
 County: **Warren**
 Location: **36-75N-24W**
 Township: **White Oak**
 Acres: **40**
 Date: **9/26/2023**

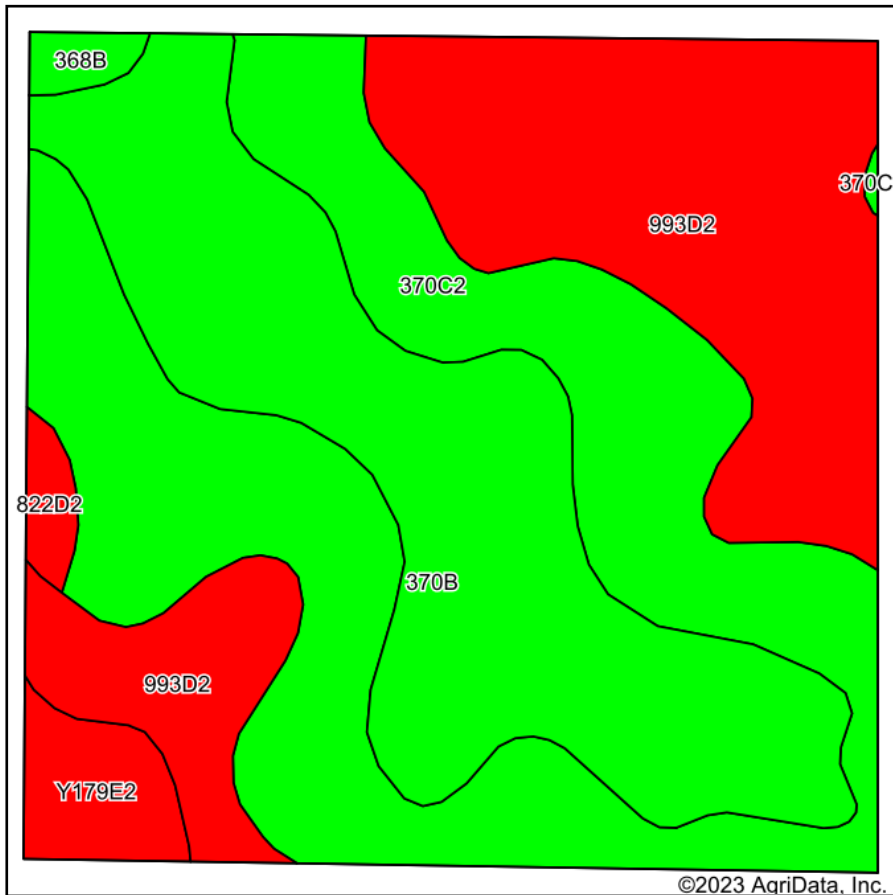

Soils data provided by USDA and NRCS.

Area Symbol: IA181, Soil Area Version: 28

Code	Soil Description	Acres	Percent of field	CSR2 Legend	Non-Irr Class *c	CSR2**	CSR	*n NCCPI Overall	*n NCCPI Corn	*n NCCPI Small Grains	*n NCCPI Soybeans
370C2	Sharpsburg silty clay loam, 5 to 9 percent slopes, eroded	15.04	37.6%		IIIe	80	67	82	82	68	65
370B	Sharpsburg silty clay loam, 2 to 5 percent slopes	11.69	29.2%		Ile	91	87	92	92	77	79
993D2	Armstrong-Gara loams, 9 to 14 percent slopes, moderately eroded	11.31	28.3%		IVe	23	20	66	66	52	47
Y179E2	Gara loam, dissected till plain, 14 to 18 percent slopes, eroded	1.22	3.0%		Vle	32		69	69	53	49
822D2	Lamoni silty clay loam, 9 to 14 percent slopes, eroded	0.40	1.0%		IVe	10	15	59	59	54	42
368B	Macksburg silty clay loam, 2 to 5 percent slopes	0.34	0.8%		Ile	89	90	87	87	79	78
Weighted Average						3.08	65	*n 79.8	*n 79.8	*n 65.6	*n 63.4

**IA has updated the CSR values for each county to CSR2.

*- CSR weighted average cannot be calculated on the current soils data, use prior data version for csr values.

*n: The aggregation method is "Weighted Average using all components"

*c: Using Capabilities Class Dominant Condition Aggregation Method

Soils data provided by USDA and NRCS.