

# Tillable Soils Map

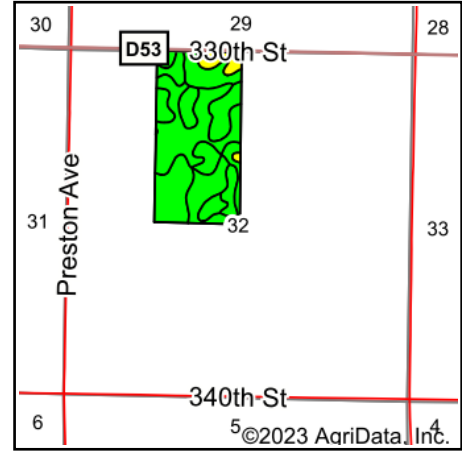

State: **Iowa**  
 County: **Calhoun**  
 Location: **32-87N-32W**  
 Township: **Logan**  
 Acres: **78.01**  
 Date: **9/19/2023**

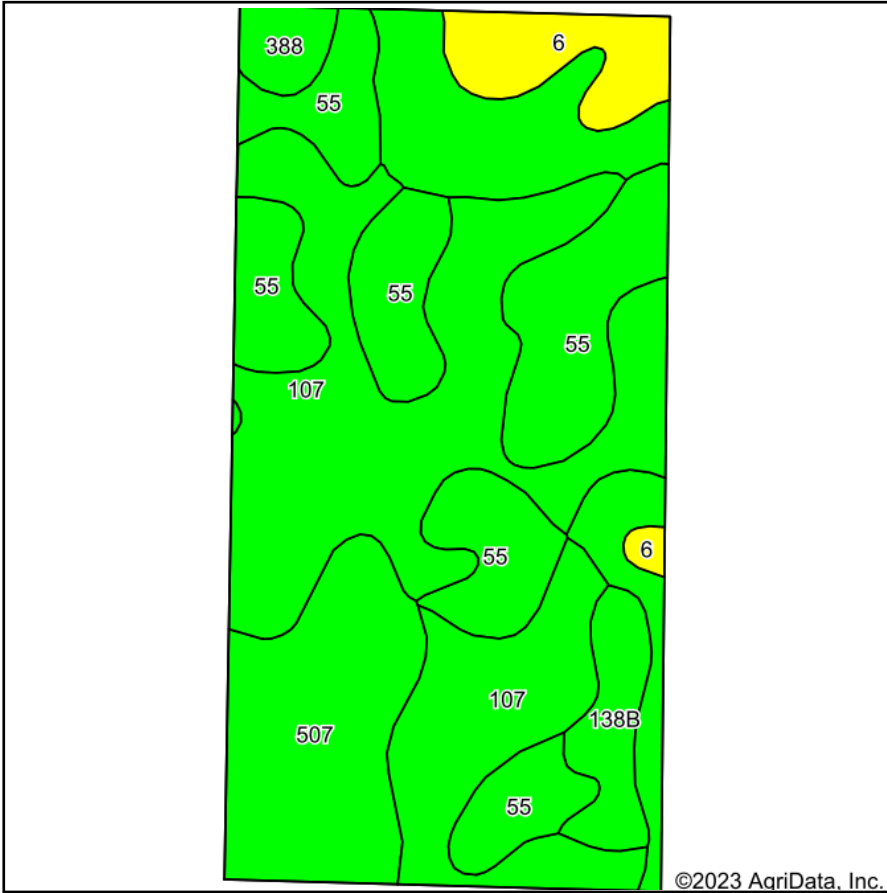

Maps Provided By:



© AgriData, Inc. 2023

www.AgriDataInc.com



Area Symbol: IA025, Soil Area Version: 32

Code	Soil Description	Acres	Percent of field	CSR2 Legend	Non-Irr Class *c	*i Corn Bu	*i Soybeans Bu	CSR2**	CSR	*n NCCPI Overall	
107	Webster clay loam, 0 to 2 percent slopes	29.30	37.6%		Ilw	224.0	65.0	86	83	82	
507	Canisteo clay loam, 0 to 2 percent slopes	20.12	25.8%		Ilw	224.0	65.0	84	78	81	
55	Nicollet clay loam, 1 to 3 percent slopes	19.90	25.5%		Iw	233.6	67.7	89	88	81	
6	Okoboji silty clay loam, 0 to 1 percent slopes	4.10	5.3%		Illw	164.8	47.8	59	57	76	
138B	Clarion loam, 2 to 6 percent slopes	3.09	4.0%		Ile	225.6	65.4	89	80	83	
388	Kossuth silty clay loam, 0 to 2 percent slopes	1.50	1.9%		Ilw	224.0	65.0	86	77	89	
<b>Weighted Average</b>						<b>1.80</b>	<b>223.4</b>	<b>64.8</b>	<b>84.9</b>	<b>81.4</b>	<b>*n 81.3</b>

\*\*IA has updated the CSR values for each county to CSR2.

\*i Yield data provided by the ISPAID Database version 8.1.1 developed by IA State University.

\*n: The aggregation method is "Weighted Average using all components"

\*c: Using Capabilities Class Dominant Condition Aggregation Method

Soils data provided by USDA and NRCS.