

Tillable Soils Map

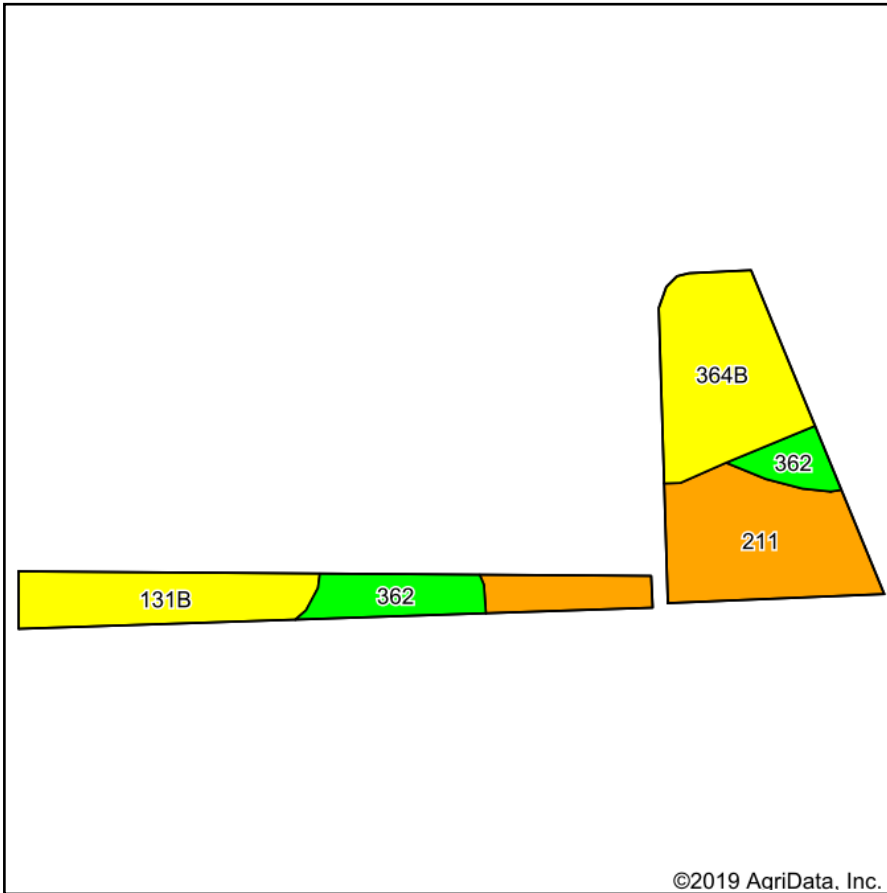

Soils data provided by USDA and NRCS.

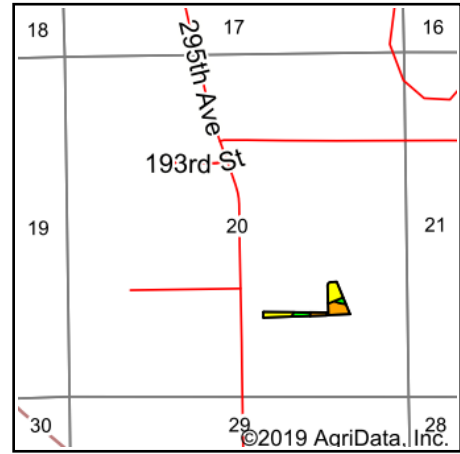

State: **Iowa**
 County: **Lee**
 Location: **20-68N-4W**
 Township: **Washington**
 Acres: **4.35**
 Date: **3/6/2019**



Maps Provided By:



© AgriData, Inc. 2019

www.AgriDataInc.com



Area Symbol: IA111, Soil Area Version: 26

Code	Soil Description	Acres	Percent of field	CSR2 Legend	Non-Irr Class *c	CSR2**	CSR
211	Edina silt loam, 0 to 1 percent slopes	1.61	37.0%		IIIw	59	60
364B	Grundy silt loam, 2 to 5 percent slopes	1.29	29.7%		Ile	73	75
131B	Pershing silt loam, 2 to 5 percent slopes	0.83	19.1%		IIIe	70	67
362	Haig silt loam, 0 to 2 percent slopes	0.62	14.3%		IIw	83	70
Weighted Average						68.7	67.2

**IA has updated the CSR values for each county to CSR2.

*c: Using Capabilities Class Dominant Condition Aggregation Method

Soils data provided by USDA and NRCS.