

Total Soils Map

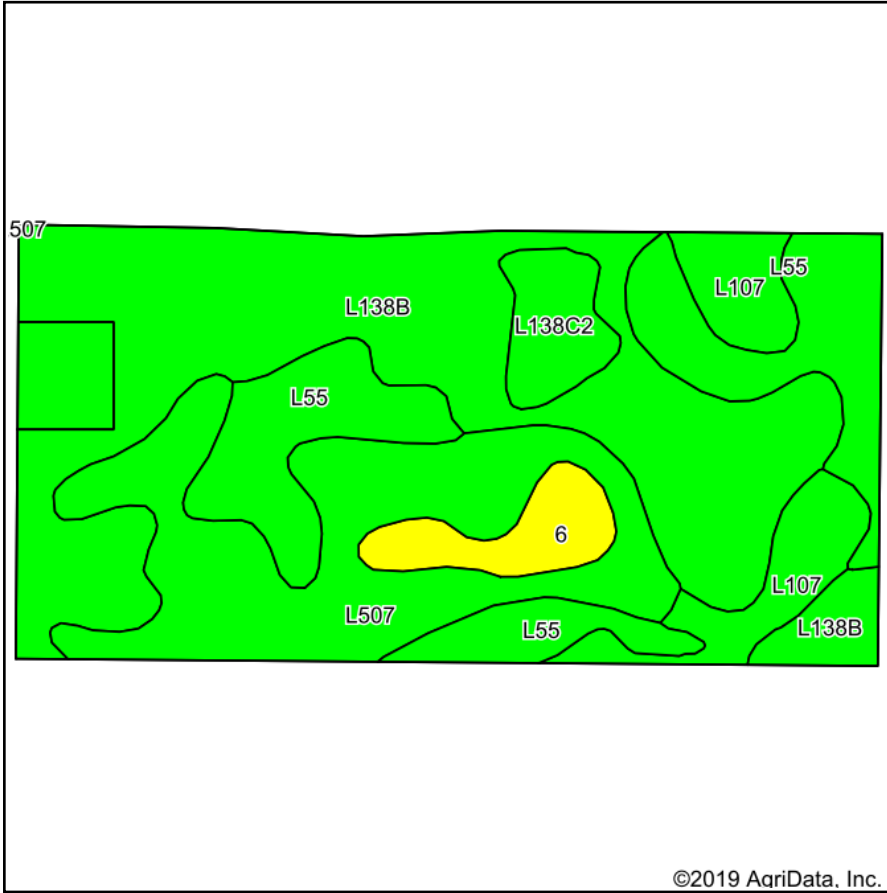

Soils data provided by USDA and NRCS.

©2019 AgriData, Inc.

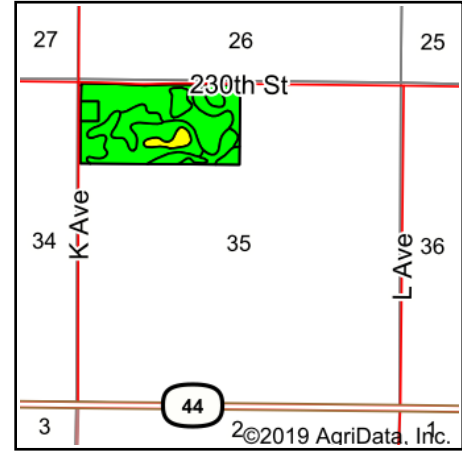

State: **Iowa**
 County: **Dallas**
 Location: **35-80N-28W**
 Township: **Washington**
 Acres: **77.84**
 Date: **1/29/2019**



Maps Provided By:



© AgriData, Inc. 2019

www.AgriDataInc.com



Area Symbol: IA049, Soil Area Version: 24

| Code | Soil Description | Acres | Percent of field | CSR2 Legend | Non-Irr Class *c | CSR2** | CSR | *n NCCPI Overall |
|-------------------------|--|-------|------------------|-------------|------------------|-----------|-----------|------------------|
| L138B | Clarion loam, Bemis moraine, 2 to 6 percent slopes | 33.37 | 42.9% | | Ile | 88 | | 79 |
| L507 | Canisteo clay loam, Bemis moraine, 0 to 2 percent slopes | 17.55 | 22.5% | | Ilw | 87 | | 79 |
| L55 | Nicollet loam, 1 to 3 percent slopes | 14.90 | 19.1% | | Ie | 91 | | 83 |
| L107 | Webster clay loam, Bemis moraine, 0 to 2 percent slopes | 6.04 | 7.8% | | Ilw | 88 | | 80 |
| 6 | Okoboji silty clay loam, 0 to 1 percent slopes | 3.14 | 4.0% | | Illw | 59 | 59 | 80 |
| L138C2 | Clarion loam, Bemis moraine, 6 to 10 percent slopes, moderately eroded | 2.84 | 3.6% | | Ille | 83 | | 60 |
| Weighted Average | | | | | | 87 | *- | *n 79.2 |

**IA has updated the CSR values for each county to CSR2.

*- CSR weighted average cannot be calculated on the current soils data, use prior data version for csr values.

*n: The aggregation method is "Weighted Average using major components"

*c: Using Capabilities Class Dominant Condition Aggregation Method

Soils data provided by USDA and NRCS.